

Tooling Balls - Imperial shoulder type - one piece construction

Gauging & Inspection

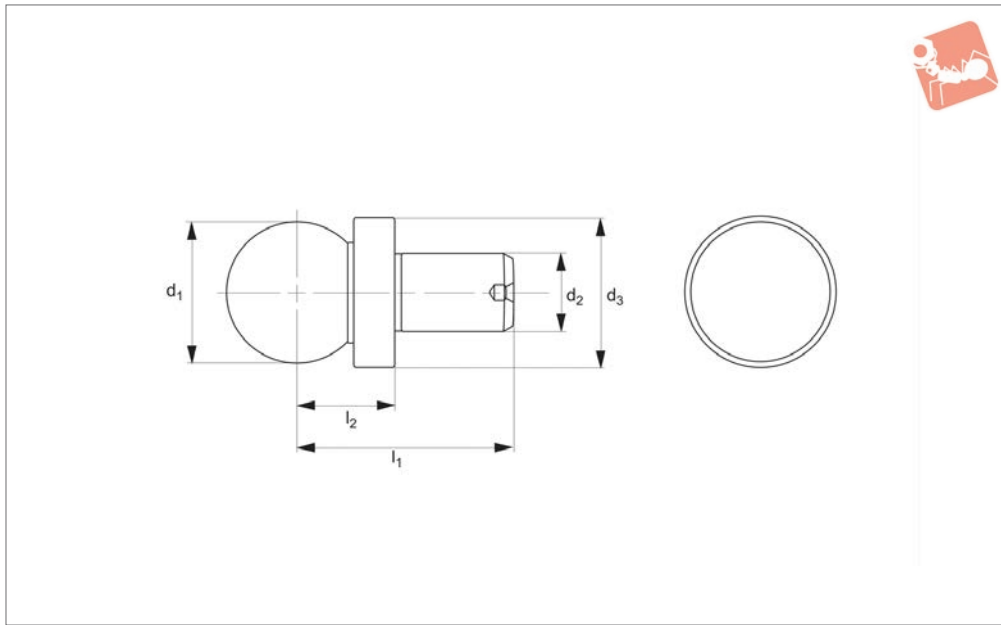

20508

GAUGING & INSPECTION

Material

Hardened and ground steel (8620 steel).

Technical Notes

Concentricity of ball to shank: ,0002 T.I.R.

Important Notes

Used as reference points for inspection applications in conjunction with CMMs to accurately measure the work piece.

All dimensions in inches.

For Press Fit d_2 tolerance

is + .0003, - .0000.

For Slip Fit d_2 tolerance

is + .0000, - .0004.

Order No.	Type	d_1 ± 0.0002	d_2 $+0.0003 -0.0000$	d_3	l_1	l_2 ± 0.0002	Weight oz
20508.W0025I	Slip Fit	0.250	0.125	1/4"	9/16"	0.200	0.16
20508.W0037I	Slip Fit	0.375	0.188	3/8"	3/4"	0.300	0.16
20508.W0050I	Slip Fit	0.500	0.250	1/2"	15/16"	0.400	0.48
20508.W0051I	Slip Fit	0.500	0.250	1/2"	1-3/8"	0.500	0.64
20508.W0075I	Slip Fit	0.750	0.375	3/4"	1-1/4"	0.500	1.60
20508.W0125I	Press Fit	0.250	0.125	1/4"	9/16"	0.200	0.16
20508.W0137I	Press Fit	0.375	0.188	3/8"	3/4"	0.300	0.16
20508.W0150I	Press Fit	0.500	0.250	1/2"	15/16"	0.400	0.48
20508.W0151I	Press Fit	0.500	0.250	1/2"	1-3/8"	0.500	0.64
20508.W0175I	Press Fit	0.750	0.375	3/4"	1-1/4"	0.500	1.60