

34770

LEVELLING FEET

Material

Bolt and shroud nut: AISI 304 stainless steel.

Pad: AISI 304 stainless steel, with inset nitrile pad.

Seal: nitrile rubber.

Technical Notes

Nut shroud is used to cover the exposed

threaded section of the machine mount, and hence prevents areas of contamination. In addition the rubber seal between base and bolt adds to the ease of cleaning.

Tips

Specifically designed for food & drink, pharmaceutical & clean room applications where hygiene is of prime importance and

ingress of materials is to be minimised.

Order No.	d ₁	l	d ₂	h ₁	Height h ₂ min.	Shroud adj. h ₃ max.	Static load kN max.
34770.W0120	M12	68	55	124	70	25	7.5
34770.W0121	M12	92	55	174	95	50	7.5
34770.W0160	M16	68	75	130	75	50	17.5
34770.W0162	M16	92	75	180	100	50	17.5
34770.W0200	M20	68	100	136	85	25	25.0
34770.W0201	M20	92	100	186	110	50	25.0



34771

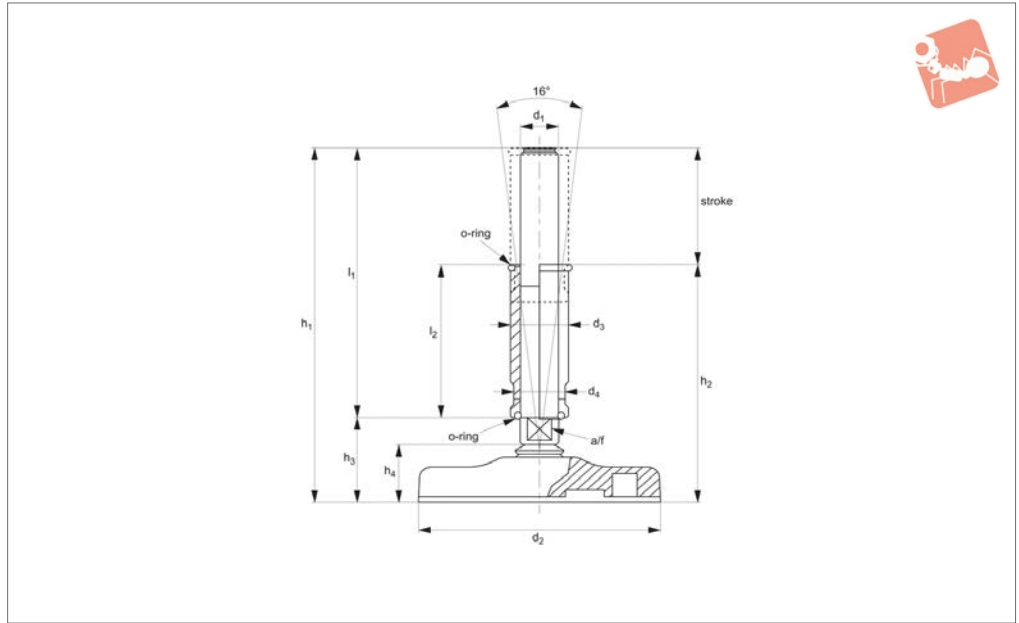

Material

Base: polyamide base.
Screw: stainless steel 304.

Technical Notes

Nut shroud is used to cover the exposed threaded section of the levelling foot, and hence prevents areas of contamination. In

addition the rubber seal between base and bolt adds to the ease of cleaning.

Load values shown are for static loads calculated at the half of the screw length. In the presence of vibrations or dynamic loads these values should be reduced.

Tips

Specifically designed for food & drink, pharmaceutical & clean room applications where hygiene is of prime importance and ingress of materials is to be minimised.

Order No.	Stroke	d ₁	d ₂	d ₃	d ₄	l ₁	l ₂	h ₁	h ₂	h ₃	A/F	Static load kN
34771.W2000	65mm	M20	103	30	26	150	85	193	128	43	17	20
34771.W2001	65mm	M20	123	30	26	150	85	195	130	45	20	30
34771.W2400	65mm	M24	103	35	30	150	85	194	129	44	17	20
34771.W2401	65mm	M24	123	35	30	150	85	196	131	46	20	30
34771.W3000	65mm	M30	123	42	36	150	85	197	132	47	26	30



Hygienic Levelling Feet

stainless steel, with rubber pad

Levelling Feet

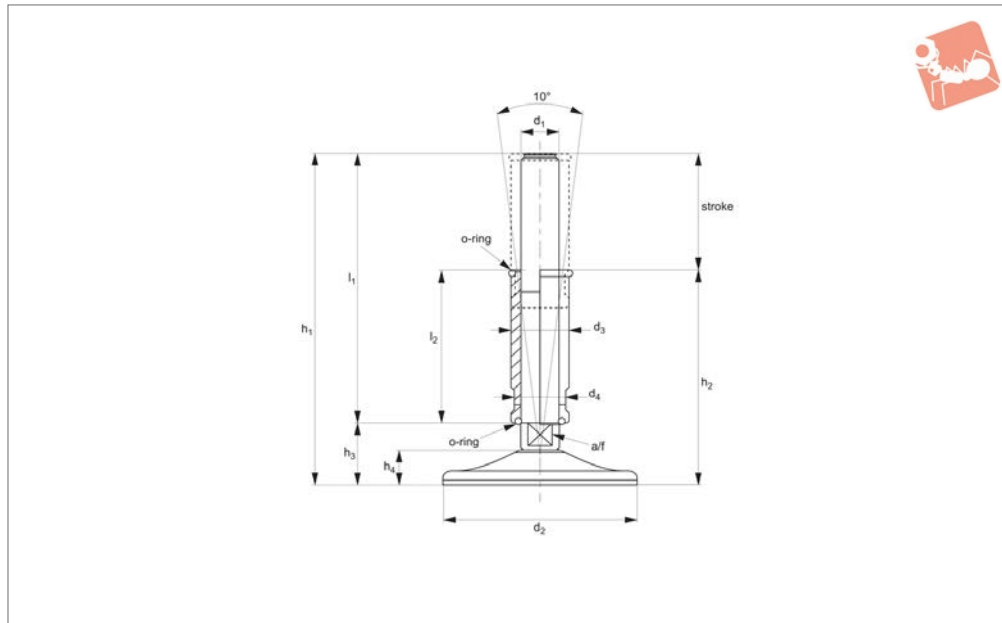

34772

LEVELLING FEET

Material

Base: stainless steel with vulcanized rubber pad.

Screw: stainless steel 304.

Technical Notes

Nut shroud is used to cover the exposed threaded section of the levelling feet, and

hence prevents areas of contamination. In addition the rubber seal between base and bolt adds to the ease of cleaning.

Load values shown are for static loads calculated at the half of the screw length. In the presence of vibrations or dynamic

loads these values should be reduced.

Tips

Specifically designed for food & drink, pharmaceutical & clean room applications where hygiene is of prime importance and ingress of materials is to be minimised.

Order No.	Stroke	d ₁	d ₂	d ₃	d ₄	l ₁	l ₂	h ₁	h ₂	h ₃	h ₄	A/F	Static load kN
34772.W1600	40mm	M16	60	24	20	125	65	160	95	35	22.0	17	7
34772.W1601	65mm	M16	60	24	20	150	85	185	120	35	22.0	17	7
34772.W1602	40mm	M16	80	24	20	125	65	163	98	38	22.0	17	10
34772.W1603	65mm	M16	80	24	20	150	85	188	123	38	25.0	17	10
34772.W1604	65mm	M16	100	24	20	150	85	193	128	43	25.0	17	15
34772.W1605	65mm	M16	120	24	20	150	85	195	130	45	25.0	17	30
34772.W1606	40mm	M16	75	24	20	125	65	153	88	28	25.0	13	20
34772.W1607	65mm	M16	100	24	20	150	85	187	122	37	30.0	17	30
34772.W2000	65mm	M20	60	30	26	150	85	185	120	35	30.0	17	7
34772.W2001	65mm	M20	80	30	26	150	85	188	123	38	30.0	17	10
34772.W2002	65mm	M20	80	30	26	200	85	238	173	38	30.0	17	10
34772.W2003	65mm	M20	100	30	26	150	85	193	128	43	30.0	17	15
34772.W2004	65mm	M20	100	30	26	200	85	243	178	43	30.0	17	15
34772.W2005	65mm	M20	120	30	26	150	85	195	130	45	30.0	17	30
34772.W2006	65mm	M20	120	30	26	200	85	245	180	45	32.0	17	30
34772.W2007	65mm	M20	100	30	26	150	85	187	122	37	32.0	17	30
34772.W2008	65mm	M20	100	30	26	200	85	237	172	37	32.0	17	30
34772.W2009	65mm	M20	120	30	26	150	85	187	122	37	32.0	17	40
34772.W2010	65mm	M20	120	30	26	200	85	237	172	37	32.0	17	40
34772.W2011	65mm	M20	150	30	26	150	85	189	124	39	32.0	17	50
34772.W2012	65mm	M20	150	30	26	200	85	239	174	39	32.0	17	50
34772.W2400	65mm	M24	100	35	30	150	85	194	129	44	18.0	20	15
34772.W2401	65mm	M24	100	35	30	200	85	244	179	44	22.0	20	15
34772.W2402	65mm	M24	120	35	30	150	85	196	131	46	22.0	20	30
34772.W2403	65mm	M24	120	35	30	200	85	246	181	46	22.0	20	30
34772.W2404	65mm	M24	100	35	30	150	85	188	123	38	22.0	20	30
34772.W2405	65mm	M24	100	35	30	200	85	238	173	38	22.0	26	30
34772.W2406	65mm	M24	120	35	30	150	85	188	123	38	22.0	20	40
34772.W2407	65mm	M24	120	35	30	200	85	238	173	38	22.0	20	40
34772.W2408	65mm	M24	150	35	30	150	85	190	125	40	22.0	20	50



Order No.	Stroke	d ₁	d ₂	d ₃	d ₄	l ₁	l ₂	h ₁	h ₂	h ₃	h ₄	A/F	Static load kN
34772.W2409	65mm	M24	150	35	30	200	85	240	175	40	22.0	20	50
34772.W3000	65mm	M30	100	42	36	150	85	195	130	45	22.0	26	15
34772.W3001	65mm	M30	100	42	36	200	85	245	180	45	22.0	26	15
34772.W3002	65mm	M30	120	42	36	150	85	197	132	47	22.0	26	30
34772.W3003	65mm	M30	120	42	36	200	85	247	182	47	22.0	26	30
34772.W3004	65mm	M30	100	42	36	150	85	189	124	39	24.5	26	30
34772.W3005	65mm	M30	100	42	36	200	85	239	174	39	24.5	26	30
34772.W3006	65mm	M30	120	42	36	150	85	189	124	39	24.5	26	40
34772.W3007	65mm	M30	120	42	36	200	85	239	174	39	24.5	26	40
34772.W3008	65mm	M30	150	42	36	150	85	191	126	41	24.5	26	50
34772.W3009	65mm	M30	150	42	36	200	85	241	176	41	24.5	26	50



Hygienic Levelling Feet - Bolt Down

stainless steel, with rubber pad

Levelling Feet

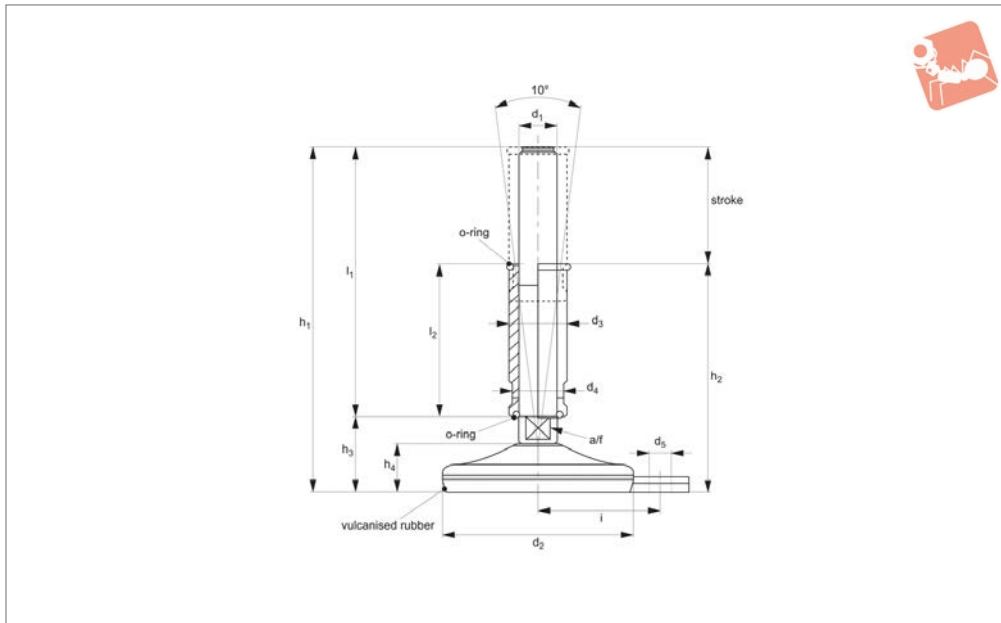

34775

LEVELLING FEET

Material

Base: stainless steel 304 with vulcanized rubber pad.

Screw: stainless steel 304.

Technical Notes

Nut shroud is used to cover the exposed threaded section of the levelling feet, and

hence prevents areas of contamination. In addition the rubber seal between base and bolt adds to the ease of cleaning.

Load values shown are for static loads calculated at the half of the screw length. In the presence of vibrations or dynamic

loads these values should be reduced.

Tips

Specifically designed for food & drink, pharmaceutical & clean room applications where hygiene is of prime importance and ingress of materials is to be minimised.

Order No.	Stroke	d ₁	d ₂	d ₃	d ₄	l ₁	l ₂	h ₁	h ₂	h ₃	h ₄	i	A/F	Static load kN
34775.W1600	40mm	M16	60	24	20	125	65	160	95	35	22	45	17	7
34775.W1601	65mm	M16	60	24	20	150	85	185	120	35	22	45	17	7
34775.W1602	40mm	M16	80	24	20	125	65	163	98	38	25	54	17	10
34775.W1603	65mm	M16	80	24	20	150	85	188	123	38	25	54	17	10
34775.W1604	65mm	M16	100	24	20	150	85	193	128	43	30	69	17	15
34775.W2000	65mm	M20	60	30	26	150	85	185	120	35	22	45	17	7
34775.W2001	65mm	M20	80	30	26	150	85	188	123	38	25	54	17	10
34775.W2002	65mm	M20	80	30	26	200	85	238	173	38	25	54	17	10
34775.W2003	65mm	M20	100	30	26	150	85	193	128	43	30	69	17	15
34775.W2004	65mm	M20	100	30	26	200	85	243	178	43	30	69	17	15
34775.W2400	65mm	M24	100	35	30	150	85	194	129	44	30	69	20	15
34775.W2401	65mm	M24	100	35	30	200	85	244	179	44	30	69	20	15
34775.W3000	65mm	M30	100	42	36	150	85	195	130	45	30	69	26	15
34775.W3001	65mm	M30	100	42	36	200	85	245	180	45	30	69	26	15



34777

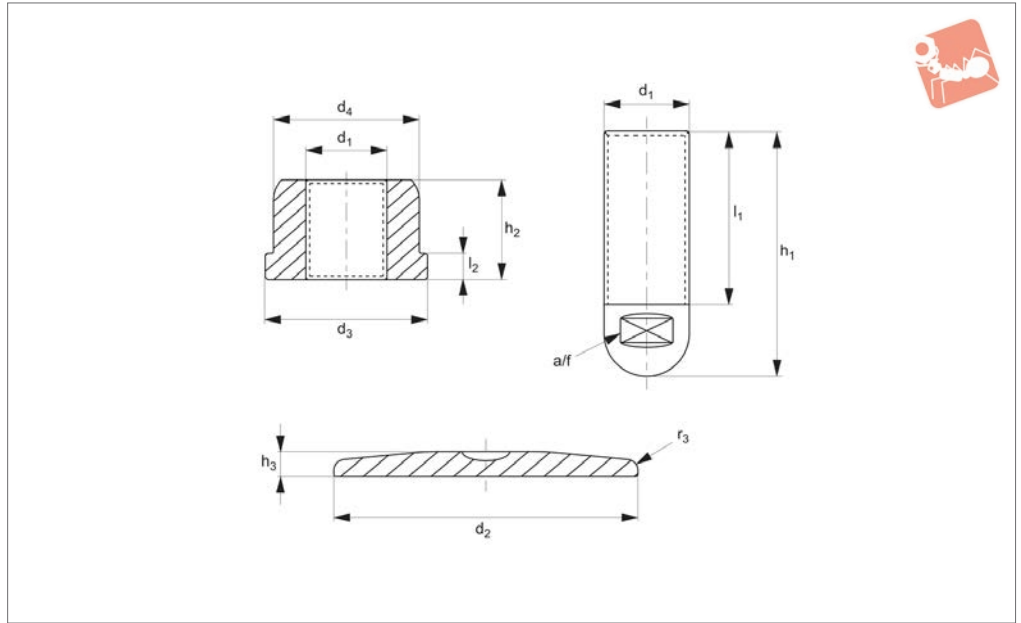

Material

Stainless steel 304

Technical Notes

Levelling system planned for dairy, phar-

maceutical and food industry in respect of the strictest hygienic regulations.

Load values shown are for static loads

calculated at the half of the screw length. In the presence of vibrations or dynamic loads these values should be reduced.

Order No.	d ₁	d ₂	d ₃	d ₄	l ₁	l ₂	h ₁	h ₂	h ₃	A/F	Static load kN
34777.W2000	M20	80	60	54	70	8	100	25	10	17	35
34777.W2400	M24	100	60	54	70	10	100	40	10	20	70
34777.W3000	M30	120	60	54	70	10	100	40	10	26	80
34777.W3001	M30	120	80	75	100	10	140	25	10	26	80
34777.W4000	M40	150	60	54	100	10	140	50	15	36	120
34777.W4001	M40	200	60	54	100	10	140	50	15	36	120



Levelling Feet - 3A Standard

hygienic line, stainless steel

Levelling Feet

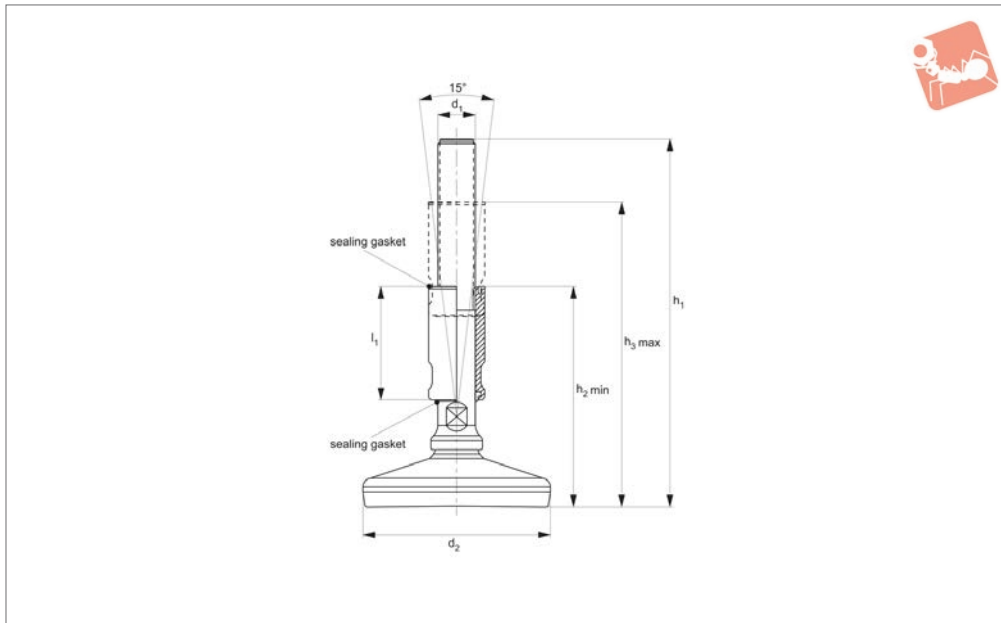

34778

LEVELLING FEET

Material

Stainless steel AISI 304.
Blue gasket: silicone.
Pad: vulcanised nitrile rubber.

Technical Notes

Nut shroud is used to cover the exposed threaded section of the machine mount,

and hence prevents contamination. Use a spanner to adjust this shroud height h_2 and h_3 , using spanner size detailed in the table.

Tips

Made to the high „3A“ standard. This ensures it meets the high standards

required for use in food, beverage, pharmaceutical and medical applications. Hygienically designed for effective and easy cleaning, corrosion resistant, non-toxic. Design precludes contamination by dirt, food particles and organic matter.

Order No.	d_1	d_2	l_1	h_1	For spanner size	Shroud adj. h_2 min.	Shroud adj. h_3 max.	Static load kN max.
34778.W1620	M16	120	60	200	13	121	166	30
34778.W1625	M16	120	85	250	13	146	216	30
34778.W2020	M20	120	60	200	17	121	166	30
34778.W2025	M20	120	85	250	17	146	216	30
34778.W2420	M24	120	60	200	20	121	166	30
34778.W2425	M24	120	85	250	20	146	216	30