

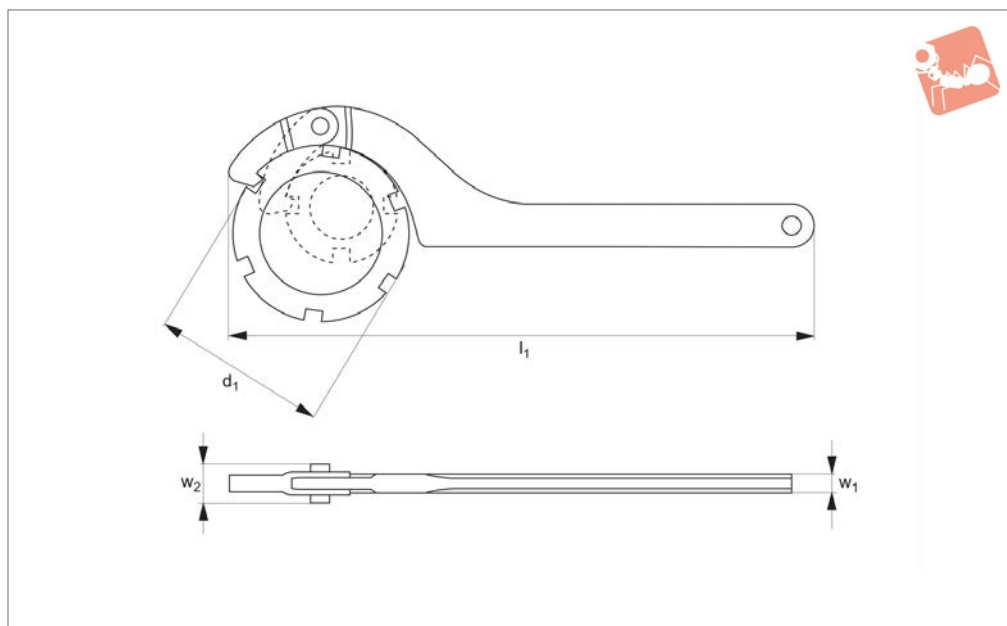

Hook Spanners - with Hook Nose hinge type - traditional

Spanners & Hook Spanners



95100

SPANNERS & HOOK SPANNERS

Material

Steel (C35/C45), hardened, blackened, or stainless steel.

Technical Notes

Spanners for adjustment of nuts to DIN 1804, DIN 981 and DIN 11851.

Rounded edges.

Order No.	Finish	d ₁ for nut Ø	Thread size of nut DIN 1804 M	Weight g
95100.W0035	Blackened steel	20-35	8-18	40
95100.W0060	Blackened steel	35-60	20-38	85
95100.W0070	Blackened steel	60-90	20-38	250
95100.W0075	Blackened steel	90-155	20-38	425
95100.W0080	Blackened steel	155-230	20-38	1015
95100.W0901	Stainless steel	20-35	8-18	35
95100.W0902	Stainless steel	35-60	20-38	75
95100.W0903	Stainless steel	60-90	40-60	185
95100.W0904	Stainless steel	90-155	58-110	320
95100.W0905	Stainless steel	155-230	105-170	860

Order No.	Thread size of nut DIN 981 M	DIN 11851-F DN	l ₁	w ₁	w ₂
95100.W0035	1-4	-	135	3	8
95100.W0060	5-8	-	175	4	11
95100.W0070	5-8	-	240	6	13
95100.W0075	5-8	-	300	7	15
95100.W0080	5-8	-	420	8	18
95100.W0901	1-4	-	135	3	8
95100.W0902	5-8	Oct-20	175	4	11
95100.W0903	9-13	25-40	240	5	13
95100.W0904	14-24	50-100	300	6	15
95100.W0905	24-36	125-150	420	8	18



95105

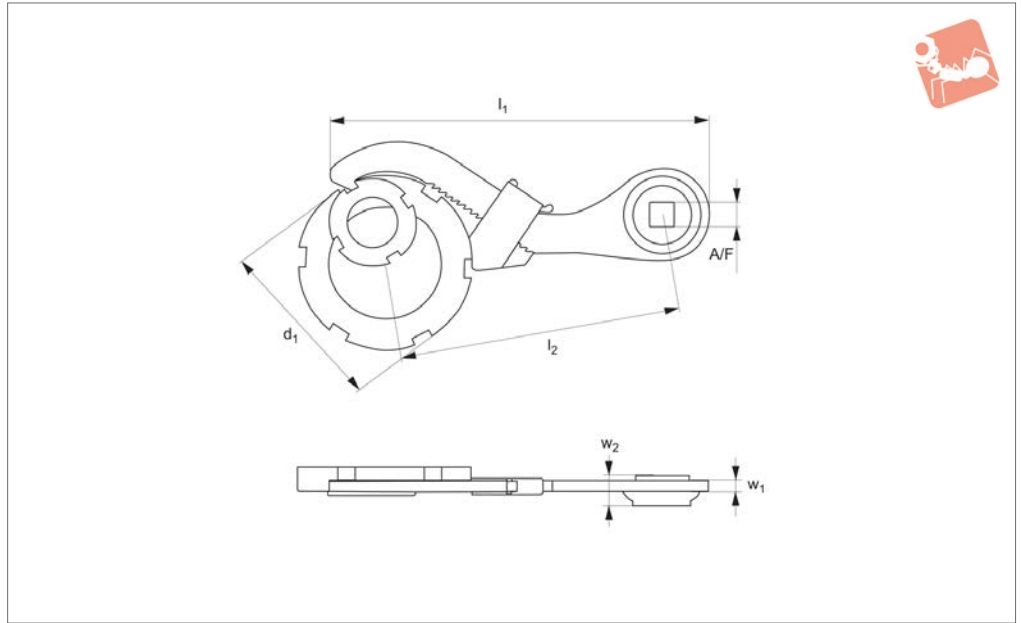

SPANNERS & HOOK SPANNERS

Material

Special steel, hardened and blued.

Technical Notes

Spanner for adjustment of nuts to DIN

1804 and DIN 981. For use with torque wrenches for more accurate installation and adjustment.

The required torque wrench value is dependent upon dimension l_2 . Please refer to the operating manual of your torque wrench.

dent upon dimension l_2 . Please refer to the operating manual of your torque wrench.

Order No.	d_1 for nut \emptyset	l_1	l_2	w_1	w_2	Drive A/F	Weight g
95105.W0042	20-42	135	100	4	16.0	1/2"	165
95105.W0090	45-90	192	150	6	16.0	1/2"	310
95105.W0165	95-165	272	200	10	16.0	1/2"	680
95105.W0166	95-165	298	220	10	20.5	3/4"	910



Hook Spanners - with Hook Nose hinge type - long version

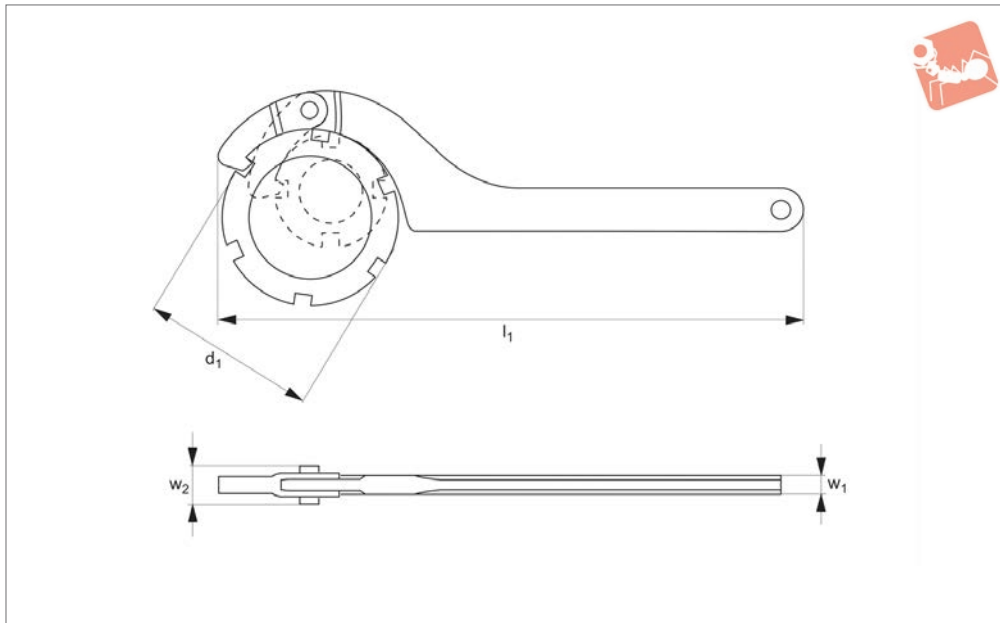

95110

Material

Steel (C35/C45), edgewise ground, hardened.

Available in steel (blackened or nickel plated), or stainless steel.

Technical Notes

Spanners for adjustment of nuts to DIN

1804, DIN 981 and DIN 11851. Extended hook and shank, strengthened rivet, spring washer.

Rounded edges for better handling.

Tips

The long version spanner allows greater torque to be applied.

Order No.	Finish	d_1 for nut \varnothing	Thread size of nut DIN 1804 M	Weight g
95110.W0035	Blackened steel	20-35	8-18	85
95110.W0060	Blackened steel	35-60	20-38	170
95110.W0090	Blackened steel	60-90	40-60	360
95110.W0155	Blackened steel	90-155	58-110	610
95110.W0230	Blackened steel	155-230	105-170	1200
95110.W0535	Nickel plated steel	20-35	8-18	85
95110.W0560	Nickel plated steel	35-60	20-38	170
95110.W0590	Nickel plated steel	60-90	40-60	360
95110.W0655	Nickel plated steel	90-155	58-110	610
95110.W0730	Nickel plated steel	155-230	105-170	1200
95110.W0901	Stainless steel	20-35	8-18	85
95110.W0902	Stainless steel	35-60	20-38	170
95110.W0903	Stainless steel	60-90	40-60	360
95110.W0904	Stainless steel	90-155	58-110	580
95110.W0905	Stainless steel	155-230	105-170	1200

Order No.	Thread size of nut DIN 981 M	DIN 11851-F DN	l_1	w_1	w_2
95110.W0035	1-4	-	165	4	10.5
95110.W0060	5-8	-	210	5	12.5
95110.W0090	9-13	-	280	6	14.5
95110.W0155	14-24	-	335	7	17.5
95110.W0230	24-36	-	460	8	17.5
95110.W0535	1-4	-	165	4	10.5
95110.W0560	5-8	-	210	5	12.5
95110.W0590	9-13	-	280	6	14.5
95110.W0655	14-24	-	335	7	17.5
95110.W0730	24-36	-	460	8	17.5
95110.W0901	1-4	-	165	4	10.5
95110.W0902	5-8	Oct-20	210	5	12.5
95110.W0903	9-13	25-40	280	6	14.5



Order No.	Thread size of nut DIN 981 M	DIN 11851-F DN	l_1	w_1	w_2
95110.W0904	14-24	50-100	335	6	17.5
95110.W0905	24-36	125-150	460	8	17.5



Hook Spanners - with Hook Nose fixed

Spanners & Hook Spanners

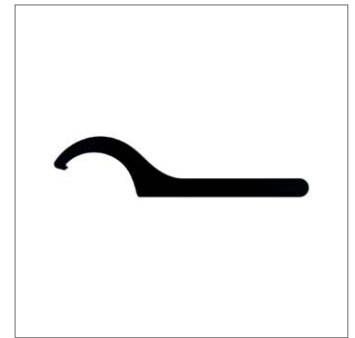
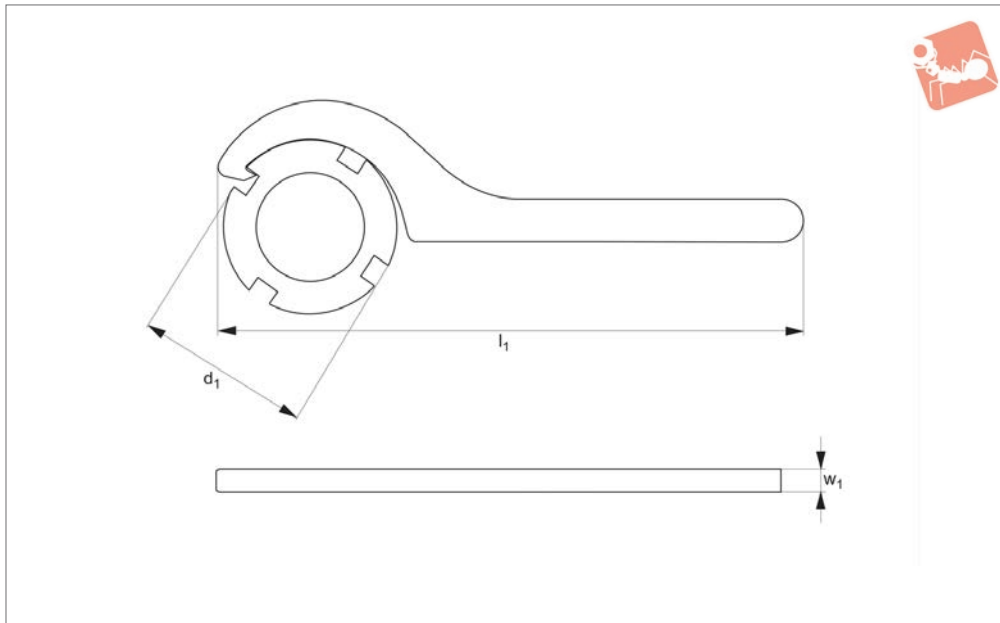

95400

SPANNERS & HOOK SPANNERS

Material

Steel (C35/C45), hardened and blackened.
Edgewise ground.

request, subject to minimum order quantities.

DIN 981.

Tips

Items marked (), width varies from DIN standard. For slotted nuts to DIN 1804 and

Technical Notes

To DIN 1810A. Specials available on

Order No.	d ₁ for nut Ø	l ₁	w ₁	Weight g
95400.W0014	12-24	110	3	25
95400.W0020	16-20	110	3	25
95400.W0028	25-28	136	4	45
95400.W0032	30-32	136	4	50
95400.W0036	34-36	170	5	90
95400.W0038	(38-45)	170	5	95
95400.W0042	40-42	170	5	90
95400.W0050	45-50	206	6	155
95400.W0055	52-55	206	6	160
95400.W0062	58-62	240	7	260
95400.W0064	(65-70)	240	7	255
95400.W0075	68-75	240	7	255
95400.W0090	80-90	280	8	410
95400.W0092	(85-92)	280	8	410
95400.W0100	95-100	280	8	405
95400.W0102	(98-105)	290	8	405
95400.W0115	110-115	335	10	745
95400.W0130	120-130	335	10	720
95400.W0146	135-145	385	10*	1000
95400.W0166	155-165	385	10*	965
95400.W0196	180-195	470	10*	1500
95400.W0221	205-220	470	10*	1580
95400.W0246	230-245	568	10*	2250
95400.W0271	260-270	568	10*	2250
95400.W0300	280-300	680	15	5150
95400.W0320	300-320	695	15	5100
95400.W0345	320-345	695	15	5200
95400.W0375	350-375	735	15	5200
95400.W0400	380-400	770	15	6700
95400.W0500	480-500	988	20	13000

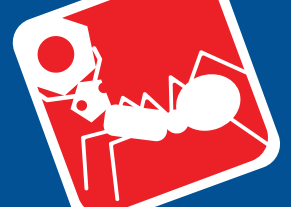



Hook Spanners - with Hook Nose

adjustable - spring loaded

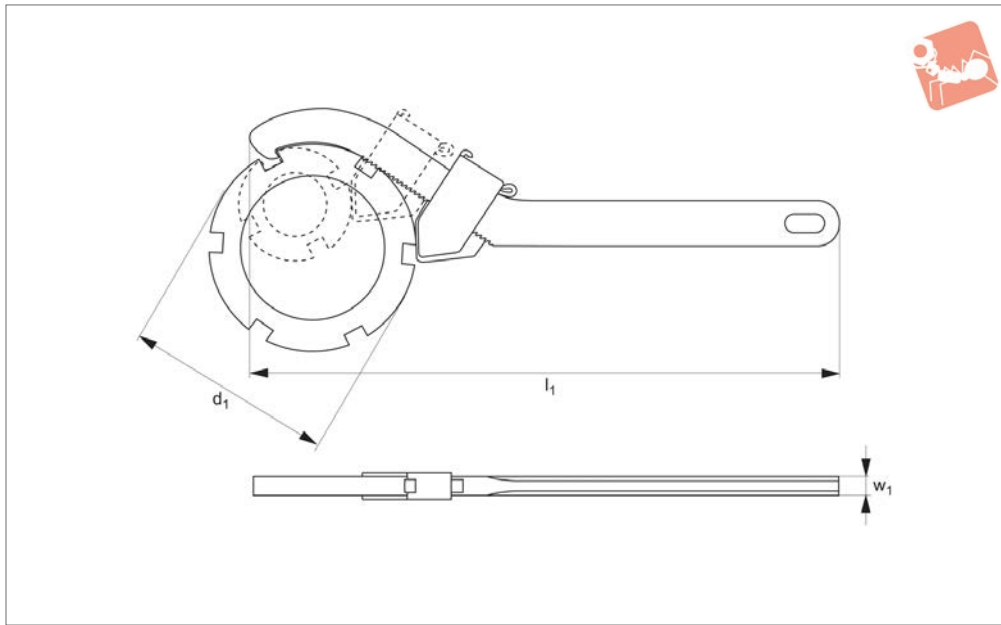

95420

SPANNERS & HOOK SPANNERS

Material

Steel (C35/C45), hardened and blackened.

Tips

For slotted nuts DIN 1804 and DIN 981.

Order No.	d ₁ for nut Ø	l ₁	w ₁	Weight g
95420.W0002	20-42	180	4	100
95420.W0005	45-90	240	6	250
95420.W0009	95-165	335	10	710





Applications and Size Ranges Hook Wrenches DIN 1810A

95400

SPANNERS & HOOK SPANNERS

Size	DIN 1804	DIN 981	DIN 981	DIN 981	KMT	DIN 70852	DIN 11851-F
	M	M	KM	KML		M	DN
12 - 14	-	-	-	-	-	-	-
16 - 20	6 8	-	-	-	-	10	-
25 - 28	10 12	15 17	2 3	-	- 0	- 16	-
30 - 32	14 16	- 20	- 4	-	- 1	- 20	-
34 - 36	18 20	-	-	-	-	- 22	-
38 - 45	26	25 30	5 6	-	-	24 -	10 15
40 - 42	22 24	-	-	-	4 -	26 28	-
45 - 50	26 28 - 30	30 -	6 -	-	-	- 35	-
52 - 55	32 35	35 -	7 -	-	-	-	20
58 - 62	38 40 - 42	40 -	8 -	-	-	- 45	- 25
65 - 70	-	45 50	9 10	-	- 9	48 52	- 32
68 - 75	45 48 - 50	- 55	- 11	-	- 10	50 55	-
80 - 90	52 - 55 58 - 60	60 -	12 -	-	- 12	60 70	-
85 - 92	-	65 70	13 14	-	-	65 -	- 50
95 - 100	62 - 65 68 - 70	-	-	-	13 14	75 80	-
98 - 105	-	75 80	15 16	-	- 15	-	-
110 - 115	72 - 75 80	85 -	17 -	-	16 -	-	65
120 - 130	85 90	90 100	18 20	-	17 19	- 105	-
135 - 145	95 100	110 120	22 -	- 24	20 22	- 115	-
155 - 165	105 - 110 115 - 120	120 - 130 130 - 140	24 26	26 28	24 26	125 135	-
180 - 195	125 - 130 140	140 - 150 150	28 30	30 -	- 32	150 -	-
205 - 220	150 160	- 170 - 190	- 34	- 38	34 -	175 180	-
230 - 245	170 180	180 -	36 -	-	-	190 -	-
Size	DIN 1804	DIN 981	DIN 981				
	M	Tr	HM				
260 - 270	190 200	220x4 210x4	3044 42 T	-	-	-	-
280 - 300	-	220x4 140x4	44 T 48 T	-	-	-	-
300 - 320	-	240x4 250x4	48 T 50 T	-	-	-	-
320 - 345	-	250x4 -	50 T -	-	-	-	-
350 - 375	-	-	-	-	-	-	-
380 - 400	-	-	-	-	-	-	-
480 - 500	-	-	-	-	-	-	-

We specialise in the non-standard, supplying a range of DIN hand tools from socket wrenches to hook spanners, pin spanners to drill drifts, and beyond. These parts have various applications for DIN and other standard nuts and tooling. **The following pages cross reference the suitability of our hand tools to specific DIN sizings.**

Adjustable Hook Wrenches with Nose

Size	DIN 1804 M	DIN 981 M	DIN 981 KM	DIN 981 KML	DIN 11851-F DN	95420 and 95105
20 - 42	8 - 24	12 - 25	1 - 5	-	10	
45 - 90	26 - 60	30 - 65	6 - 13	-	15 - 50	
95 - 165	62 - 120	75 - 140	15 - 26	24 - 28	65 - 100	

Hook Wrenches

Size	DIN 1804 M	DIN 981 M	DIN 981 KM	DIN 981 KML	DIN 11851-F KMT	DIN 11851-F DN	DIN 70852 M	95100 and 95110
20 - 35	8 - 18	12 - 20	1 - 4	-	0 - 2	-	10 - 20	
35 - 60	20 - 38	25 - 40	5 - 8	-	3 - 7	10 - 20	22 - 42	
60 - 90	40 - 60	45 - 65	9 - 13	-	8 - 12	25 - 40	42 - 70	
90 - 155	58 - 110	70 - 130	14 - 24	24, 26	13 - 24	50 - 100	70 - 125	
155 - 230	105 - 170	120 - 190	24 - 36	26 - 38	24 - 38	125 - 150	125 - 190	

Hook Wrenches DIN 1810B

1810B Size	DIN 1816 M	776 Size	1810B Size	DIN 1816 M	776 Size	95151, 95152, 95450, 95154
16 - 18	6	16 - 22		72	95 - 155	
20 - 22	8	22 - 35	110 - 115	75	95 - 155	
25 - 28	10	22 - 35		80	95 - 155	
30 - 32	12	22 - 35	120 - 130	85	95 - 155	
	14	22 - 35		90	95 - 155	
	16	22 - 35	135 - 145	95	95 - 155	
34 - 36	18	22 - 35		100	95 - 155	
	20	35 - 60		105	95 - 155	
40 - 42	22	35 - 60	155 - 165	110	95 - 155	
	24	35 - 60		115	165 - 230	
	26	35 - 60		120	165 - 230	
45 - 50	28	35 - 60		125	165 - 230	
	30	35 - 60	180 - 195	130	165 - 230	
	32	35 - 60		140	165 - 230	
52 - 55	35	35 - 60	205 - 220	150	165 - 230	
	38	35 - 60		160	165 - 230	
58 - 62	40	60 - 90	230 - 245	170	165 - 230	
	42	60 - 90		180	-	
	45	60 - 90	260 - 270	190	-	
68 - 75	48	60 - 90		200	-	
	50	60 - 90				
	52	60 - 90				
80 - 90	55	60 - 90				
	58	60 - 90				
	60	60 - 90				
95 - 100	62	95 - 155				
	65	95 - 155				
	68	95 - 155				
	70	95 - 155				



95151

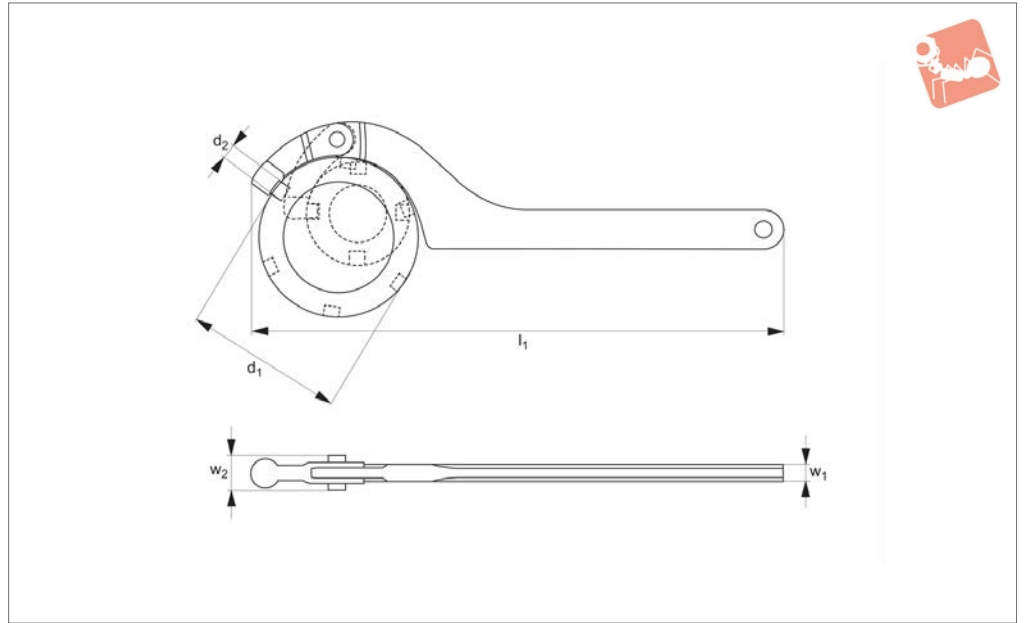

Material

Steel (C35/C45), tempered, hardened, with brown finish.

Edgewise ground.

circumferences to DIN 1816.

Technical Notes

For round nuts with set pin holes on outer

Order No.	d ₁ for nut Ø	d ₂	l ₁	w ₁	w ₂	Weight g
95151.W0035	20-35	2.5	135	3	8	40
95151.W0036	20-35	3.0	135	3	8	40
95151.W0060	35-60	4.0	175	4	11	85
95151.W0061	35-60	5.0	175	4	11	85
95151.W0090	60-90	5.0	245	6	13	250
95151.W0091	60-90	6.0	245	6	13	250
95151.W0155	90-155	6.0	300	7	15	425
95151.W0156	90-155	8.0	300	7	15	425
95151.W0230	155-230	8.0	420	8	18	1015



Hook Spanners - with Pin Nose hinge type - long version

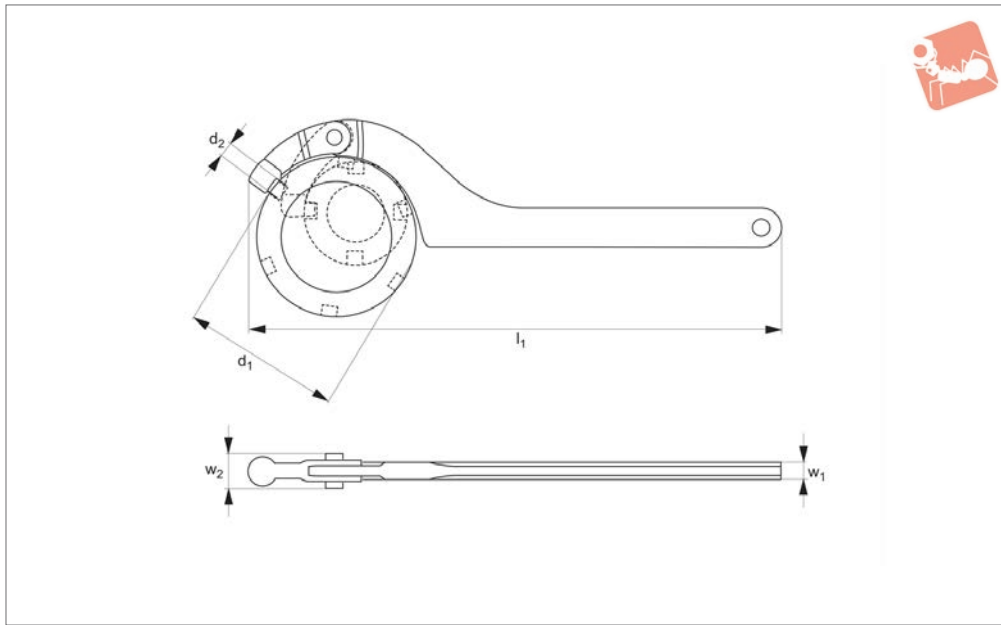

95152

Material

Steel (C35/C45), tempered, hardened, blue finish or nickel plated. Edgewise ground.

circumferences to DIN 1816.

Rounded edges for better handling. Sizes 16-22 without retaining ring.

Technical Notes

For round nuts with set pin holes on outer

Tips

Longer handle shaft (l_1) enables higher torque to be applied.

Order No.	Finish	d_1 for nut \varnothing	d_2	l_1	w_1	w_2	Weight g
95152.W0122	Blackened	16-22	2.5	135	3	7.5	50
95152.W0135	Blackened	22-35	3.0	165	4	10.5	85
95152.W0160	Blackened	35-60	4.0	205	5	12.5	170
95152.W0190	Blackened	60-90	5.0	280	6	14.5	380
95152.W0191	Blackened	60-90	6.0	280	6	14.5	380
95152.W0255	Blackened	95-155	6.0	335	7	17.5	610
95152.W0256	Blackened	95-155	8.0	335	7	17.5	610
95152.W0330	Blackened	165-230	8.0	460	8	17.5	1200
95152.W0331	Blackened	165-230	10.0	460	8	17.5	1200
95152.W0622	Nickel plated	16-22	2.5	135	3	7.5	50
95152.W0635	Nickel plated	22-35	3.0	165	4	10.5	85
95152.W0660	Nickel plated	35-60	4.0	205	5	12.5	170
95152.W0690	Nickel plated	60-90	6.0	280	6	14.5	380
95152.W0755	Nickel plated	95-155	6.0	335	7	17.5	610
95152.W0830	Nickel plated	165-230	10.0	460	8	17.5	1200



95154

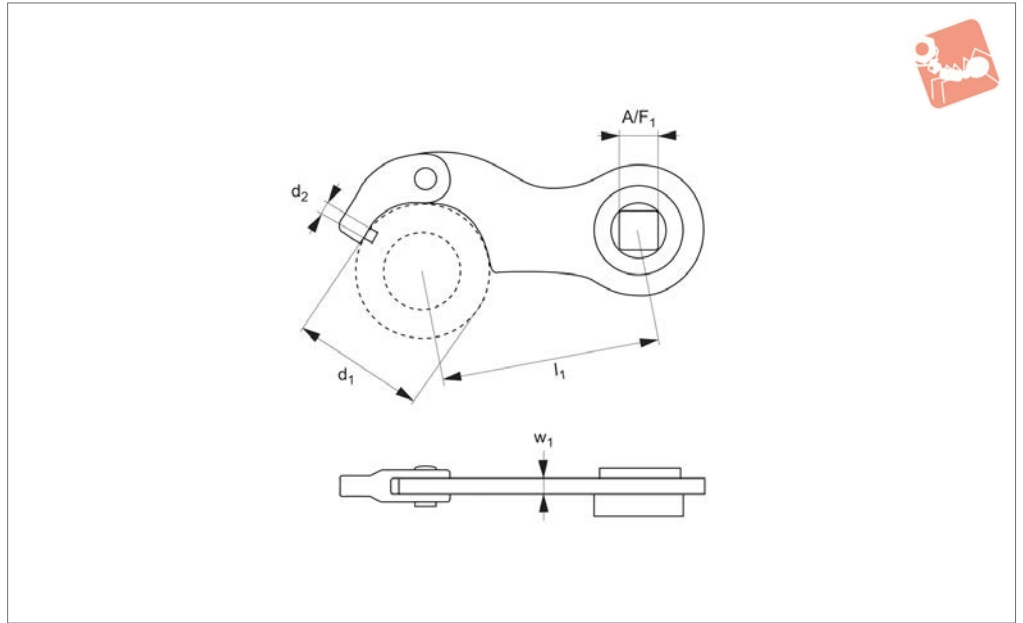

SPANNERS & HOOK SPANNERS

Material

Special steel, hardened and blued.
Drive: square socket.

Technical Notes

For nuts with radial holes to DIN 1816.

Order No.	d_1 min. max.	A/F	d_2	l_1	w_1	Weight g
95154.W0160	35-60	1/2"	4	75	5	185
95154.W0191	60-90	1/2"	6	100	6	320



Hook Spanners - with Pin Nose fixed

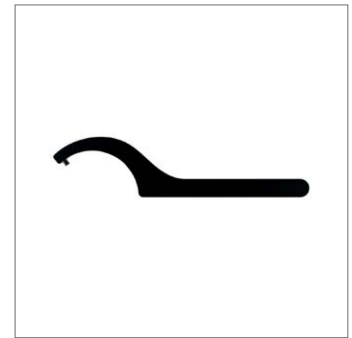
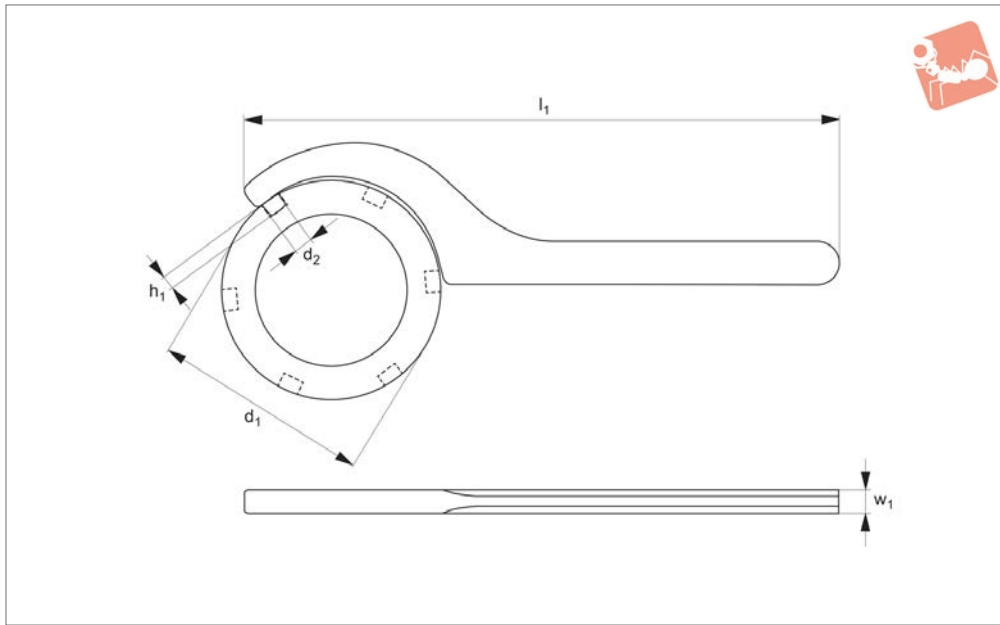

95450

Material

Body: steel (C35/C45), hardened and blackened. Edgewise ground.

including stainless steel models - subject to minimum order quantities.

holes to DIN 1816.

Technical Notes

To DIN 1816. Specials available on request,

Tips

Items marked (), width varies from DIN standard. For round nuts with set pin

Order No.	d ₁ for nut Ø	d ₂	l ₁	w ₁	h ₁	Weight g
95450.W0014	12-14	2.0	110	3	2.0	25
95450.W0018	16-18	2.5	110	3	2.5	25
95450.W0022	20-22	2.5	110	3	2.5	25
95450.W0028	25-28	3.0	136	4	3.0	55
95450.W0032	30-32	4.0	136	4	3.0	55
95450.W0036	34-36	4.0	170	5	3.5	100
95450.W0042	40-42	4.0	170	5	3.5	100
95450.W0050	45-50	5.0	206	6	4.0	165
95450.W0055	52-55	5.0	206	6	4.0	165
95450.W0062	58-62	5.0	240	7	5.0	270
95450.W0075	68-75	6.0	240	7	5.0	270
95450.W0090	80-90	6.0	280	8	6.0	410
95450.W0100	95-100	8.0	280	8	6.0	410
95450.W0115	110-115	8.0	335	(8)	8.0	610
95450.W0130	120-130	8.0	335	(8)	8.0	610
95450.W0146	135-145	8.0	380	(8)	8.0	790
95450.W0166	155-165	8.0	380	(8)	8.0	790
95450.W0196	180-195	10.0	470	(10)	8.0	1500
95450.W0221	205-220	10.0	470	(10)	8.0	1580
95450.W0246	230-245	10.0	568	(10)	10.0	2250
95450.W0271	260-270	10.0	568	(10)	10.0	2250

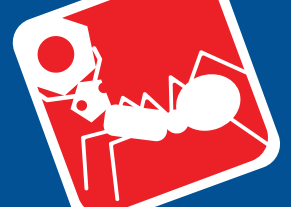



Spanner for Shell and Mill Arbors

for screws to DIN 6367

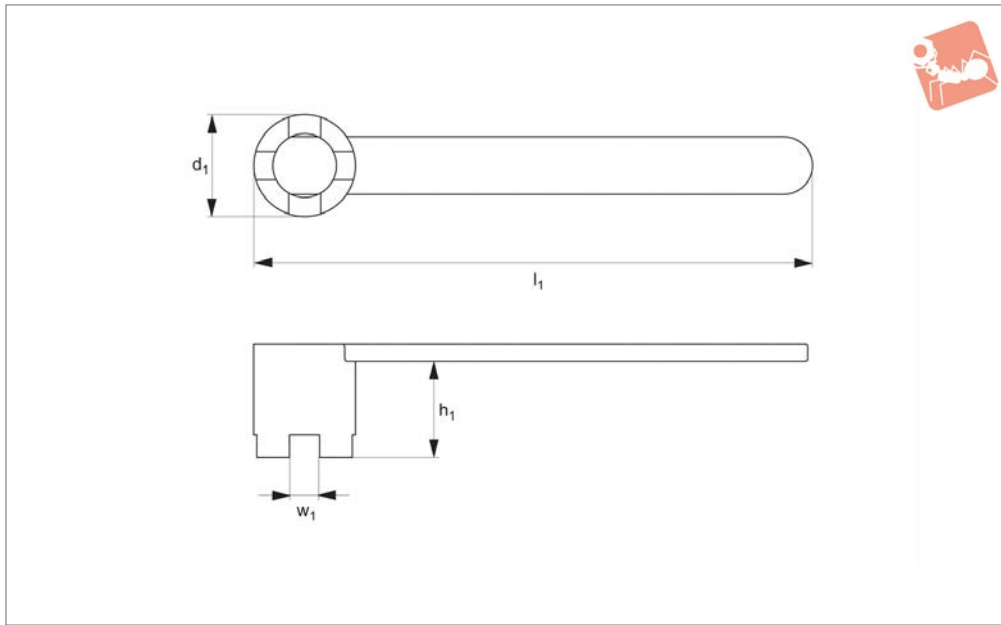

92100

Material

Steel (C35/C45) hardened, tempered, with brown finish.

Technical Notes

Nominal size refers to diameter of mandrel on milling arbor.

Order No.	Size	For nut to DIN 6367	d_1	h_1	l_1	w_1	Weight g
92100.W0013	13	M 6	18	16	160	6.1	75
92100.W0016	16	M 8	22	20	180	8.1	110
92100.W0022	22	M10	28	25	200	10.1	200
92100.W0027	27	M12	35	32	225	12.1	400
92100.W0032	32	M16	42	36	250	16.1	570
92100.W0040	40	M20	52	40	280	20.2	800
92100.W0050	50	M24	63	45	315	24.2	1100
92100.W0060	60	M30	76	50	355	28.2	1750





92120

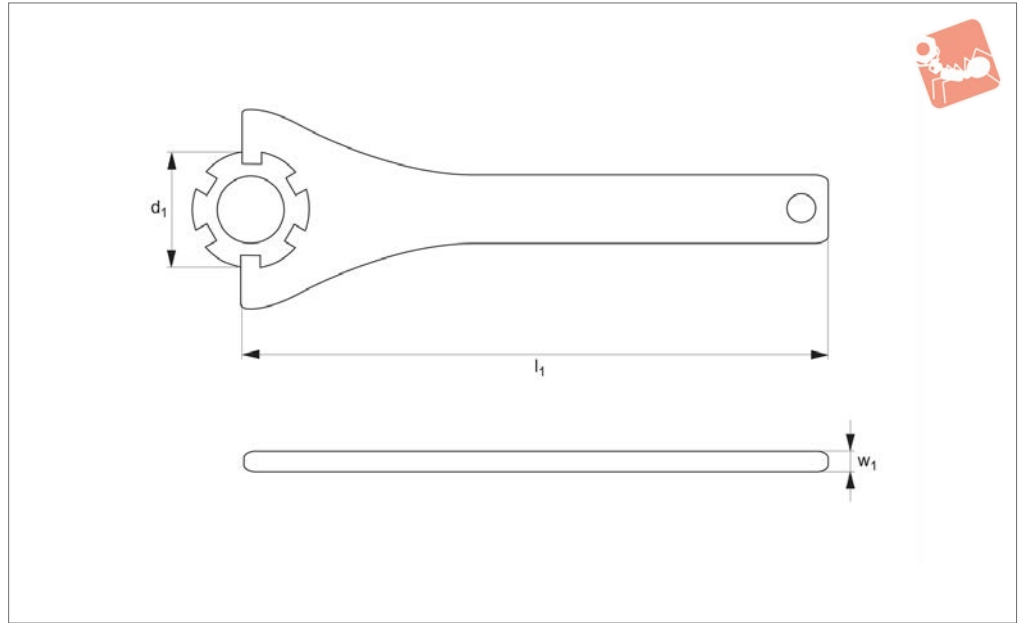

Material

Steel (C35/C45), hardened, zinc plated.

Technical Notes

For use on clamping nuts to DIN 6499D.

Order No.	Size	For nut to DIN 6499D	d_1	l_1	w_1	Weight g
92120.W0016	16	16	32	163	4	125
92120.W0020	20	20	35	183	5	190
92120.W0025	25	25	42	203	6	255
92120.W0032	32	32	50	253	6	359
92120.W0040	40	40	63	285	6	480
92120.W0050	50	-	78	350	7	810

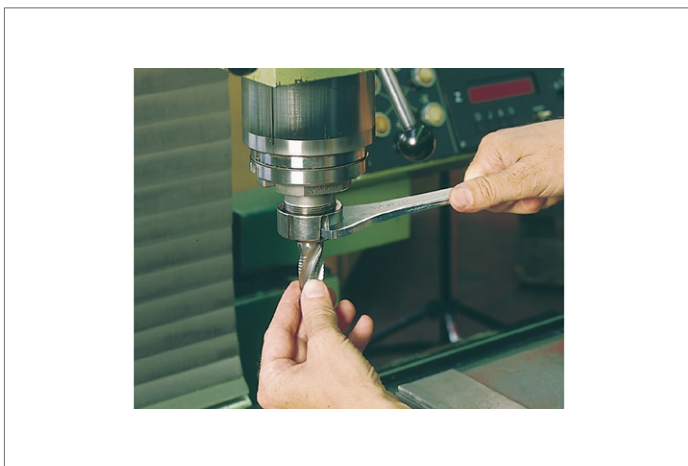



Collet Spanner

for use with torque wrench

Spanners & Hook Spanners

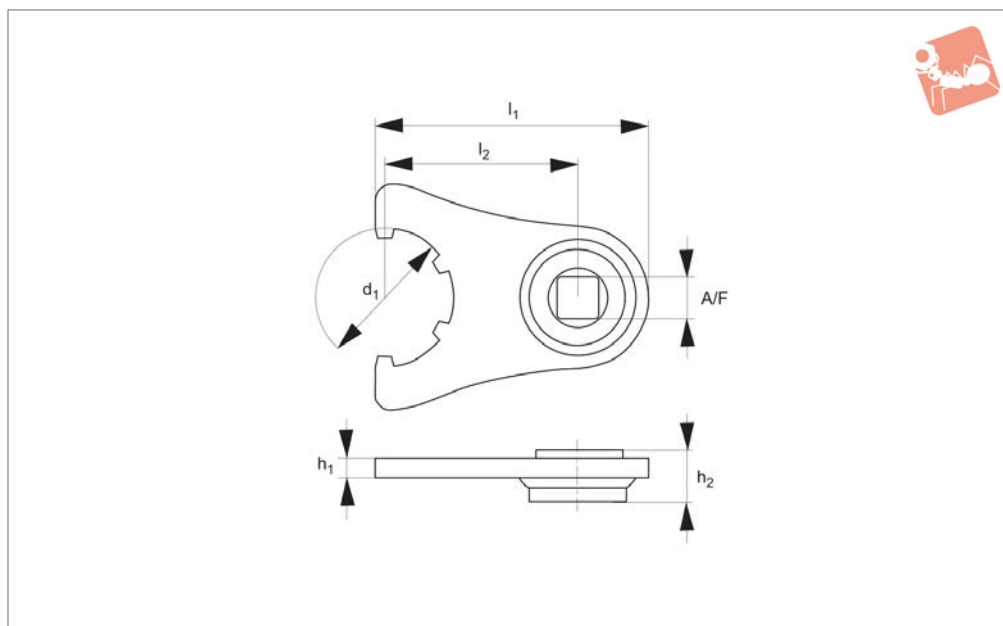

92121

SPANNERS & HOOK SPANNERS

Material

Special steel, hardened and zinc-plated.

Technical Notes

Controlled tightening prevents damage to spindle changing tools on machines.

Order No.	Size	A/F	d ₁	h ₁	h ₂	l ₁	l ₂	Weight g
92121.W0016	16	1/2"	32	5	16	69	45	140
92121.W0025	25	1/2"	42	6	16	85	60	200
92121.W0032	32	1/2"	50	6	16	85	60	215
92121.W0040	40	1/2"	63	6	16	85	60	220



92122

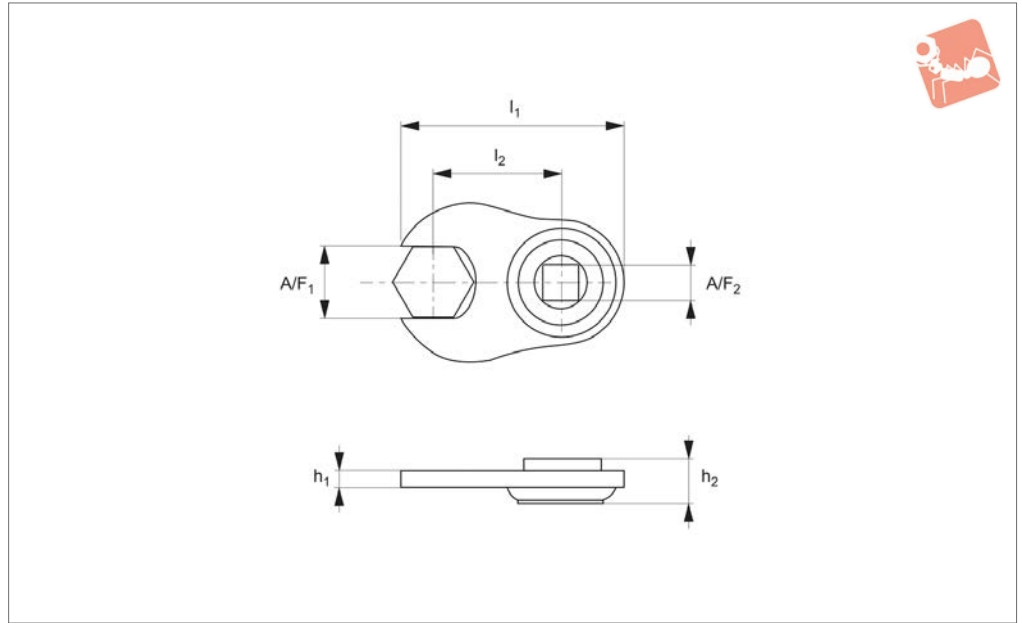

SPANNERS & HOOK SPANNERS

Material

Special steel, hardened and zinc-plated.

Technical Notes

Controlled tightening prevents damage to spindle changing tools on machines.

Order No.	A/F ₁	A/F ₂	h ₁	h ₂	l ₁	l ₂	Weight g
92122.W0025	25	1/2"	6	16	78	45	170
92122.W0036	36	1/2"	7	16	101	60	255
92122.W0046	46	1/2"	8	16	108	60	340

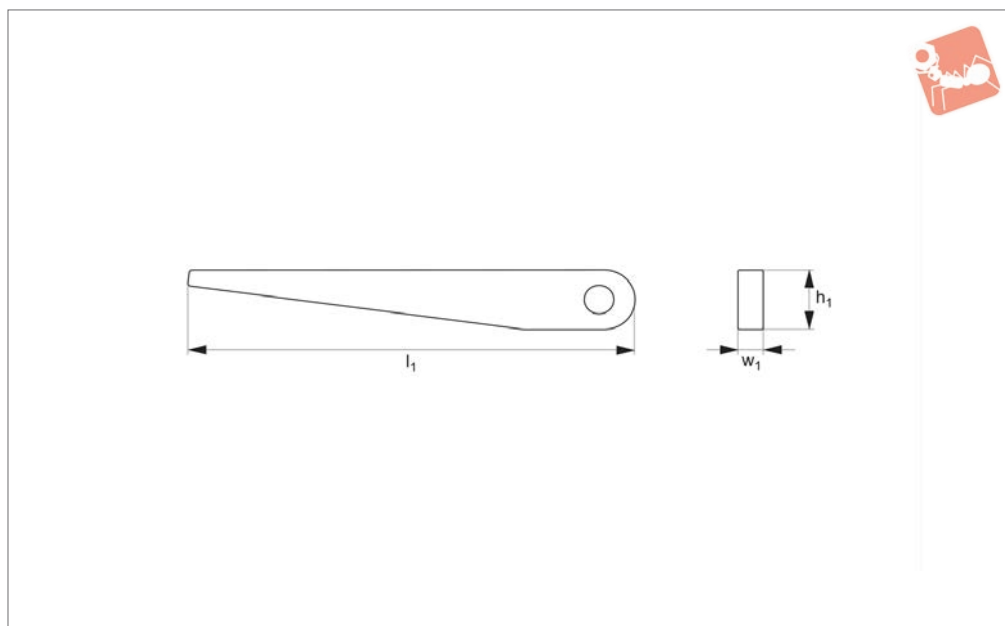

92200

SPANNERS & HOOK SPANNERS

Material

Steel (C35/C45), hardened and brown finish.

Technical Notes

Produced to DIN 317.
For machine tapers DIN 228.

Order No.	Size	Morse taper	h_1	Taper metric	l_1	w_1	Weight g
92200.W0000	0	0	12	4 & 6	90	3	14
92200.W0001	1	1 & 2	20	-	140	5	70
92200.W0003	3	3	25	-	190	7	150
92200.W0004	4	4	30	-	225	10	310
92200.W0005	5	5 & 6	35	-	265	15	650



92220

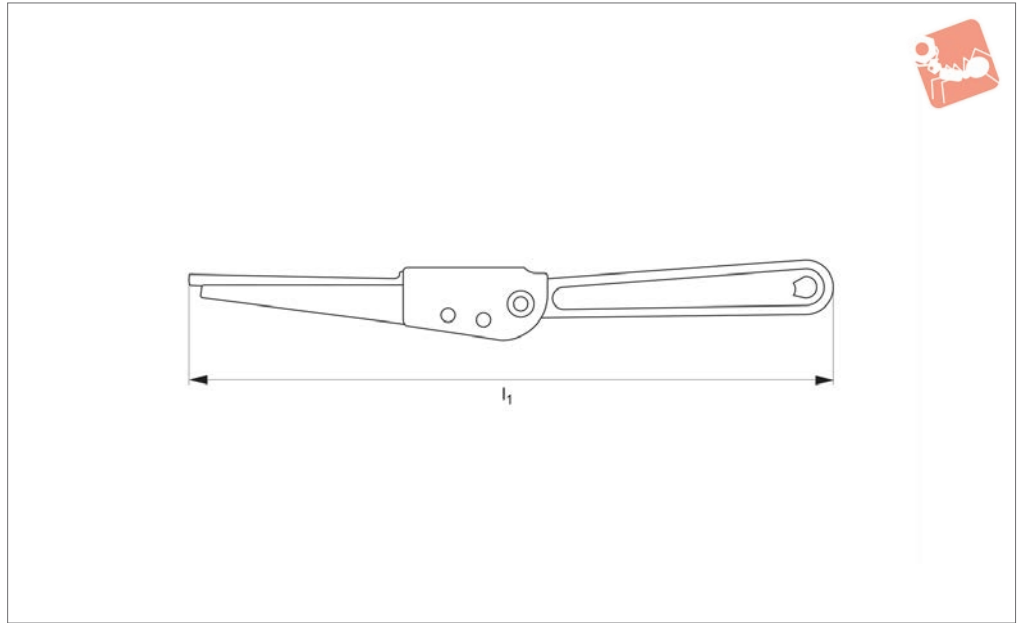

Material

Body: steel (C35/C45), hardened and blackened.
Grip: powder coated, red.

With finger protection.

Tips

This semi-automatic drill drift simplifies

the removal of machine tapers (to DIN 228).

Order No.	For morse taper	l_1	Weight g
92220.W0003	1-3	330	370
92220.W0006	4-6	380	530





Adjustable Pin Face Spanners with welded pins

Spanners & Hook Spanners

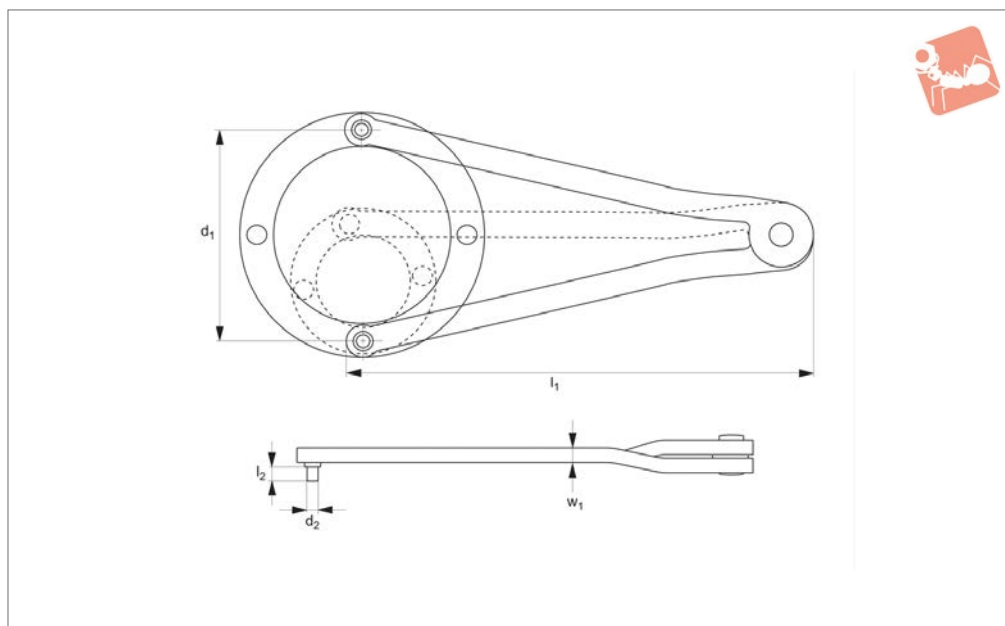

94000.1

SPANNERS & HOOK SPANNERS

Material

Carbon steel (C35/C45), tempered.

Technical Notes

Size 7-40 with riveted pins, from size 11-60 pins electrically welded.

Order No.	d ₁ for nut min. max.	d ₂ -0.1mm tol. h12	l ₁	l ₂	w ₁	Weight g
94000.W0041	7-40	1.5	115	2.0	3	40
94000.W0042	7-40	2.0	115	2.5	3	40
94000.W0043	7-40	2.5	115	3.0	3	40
94000.W0061	11-60	3.0	160	4.0	4	140
94000.W0062	11-60	4.0	160	5.0	4	140
94000.W0063	11-60	5.0	160	6.0	4	140
94000.W0101	14-100	5.0	215	6.0	6	300
94000.W0102	14-100	6.0	215	7.0	6	300
94000.W0103	14-100	8.0	215	8.0	6	300
94000.W0125	22-125	8.0	260	8.0	6	500
94000.W0126	22-125	10.0	260	10.0	6	500
94000.W0127	22-125	12.0	260	12.0	6	500



94000.2

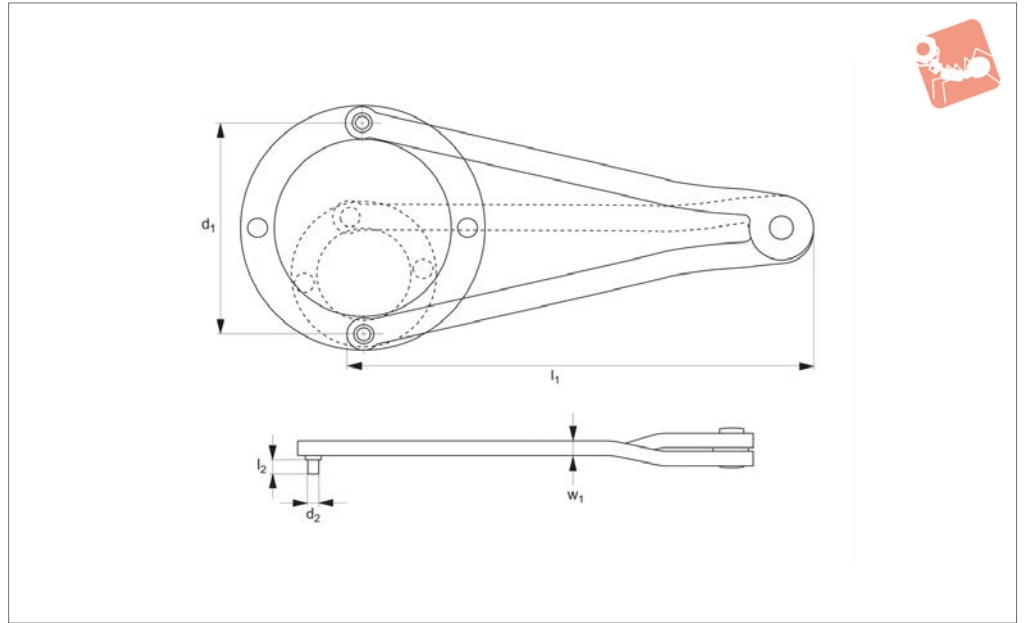

Material

Stainless steel.

Order No.	d_1 for nut min. max.	d_2 -0.1mm tol. h12	l_1	l_2	w_1	Weight g
94000.W0561	11-60	3	162	4	4	115
94000.W0562	11-60	4	162	5	4	115



Adjustable Pin Face Spanner - Off set with welded pins

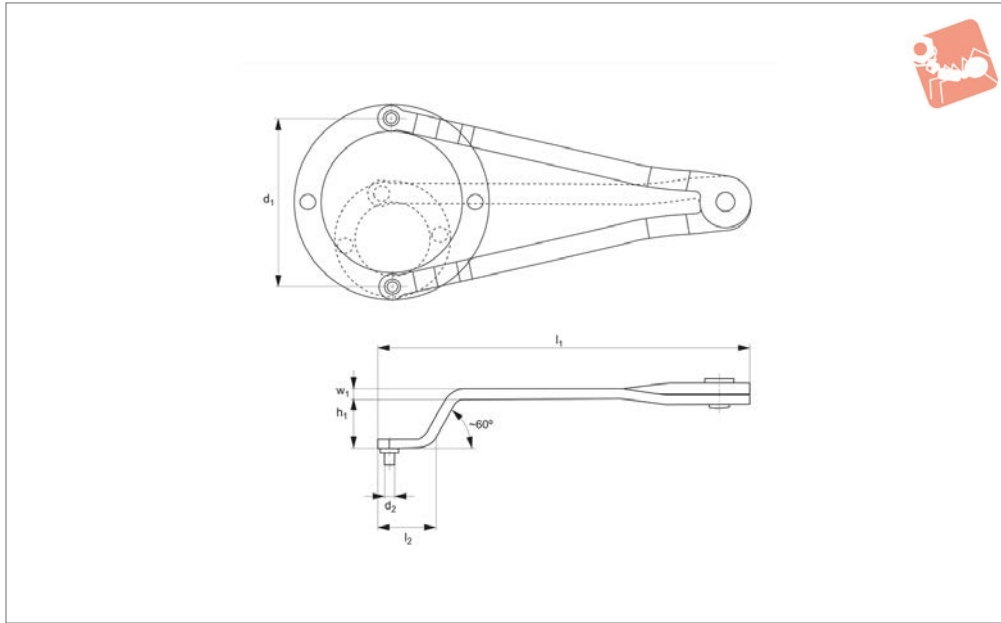

94002

SPANNERS & HOOK SPANNERS

Material

Special steel, hardened and blued.

Order No.	d_1 for nut \emptyset	d_2 -0.1mm tol. h12	h_1	l_1	l_2	w_1	Weight g
94002.W0061	11-60	3	20	153	24	4	120
94002.W0062	11-60	4	20	153	24	4	120
94002.W0101	14-90	5	27	205	31	6	310
94002.W0102	14-90	6	27	205	31	6	310

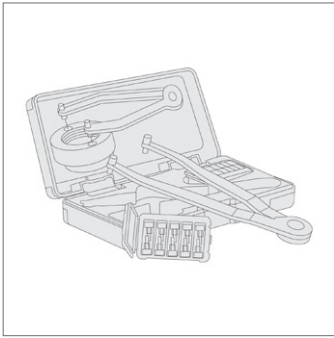

94020

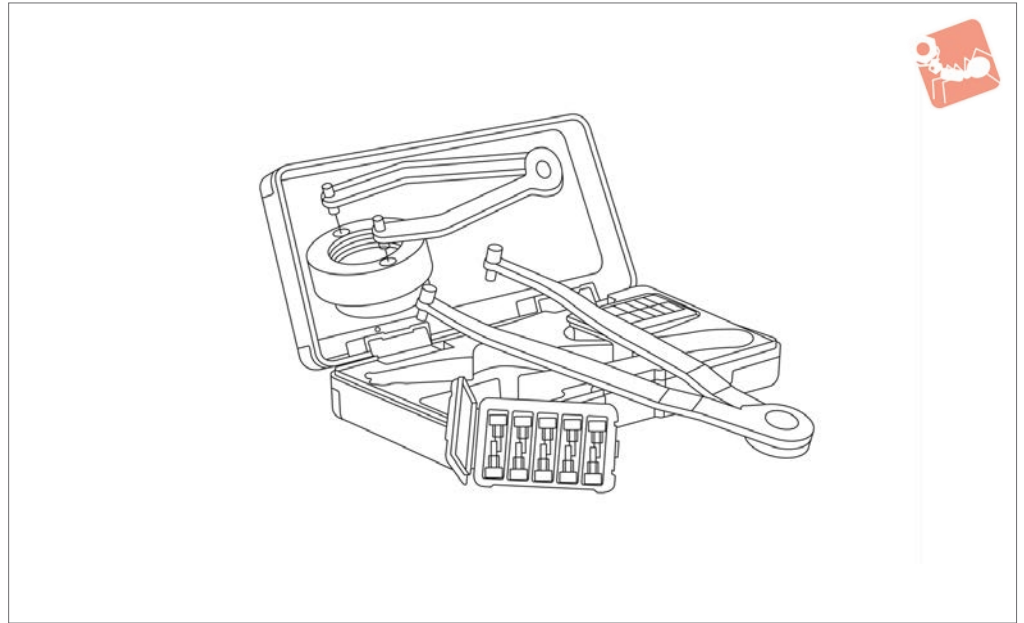

Material

Spanner: steel (C35/C45), zinc plated.
Pins: hardened steel, blackened.

Technical Notes

Set contains 1 pieces adjustable pin face

spanner to suit interchangeable pins. Pin set contains two pieces each of pin diameter 1.5, 2, 2.5, 3 and 4. Supplied in robust storage box.

Order No.	Box l x w x h	For nut diameter	Pin diameter	Weight g
94020.W0061	165x87x36	8-100	1.5, 2, 2.5, 3, 4	335



Face Spanner - with Pins

fixed

Spanners & Hook Spanners

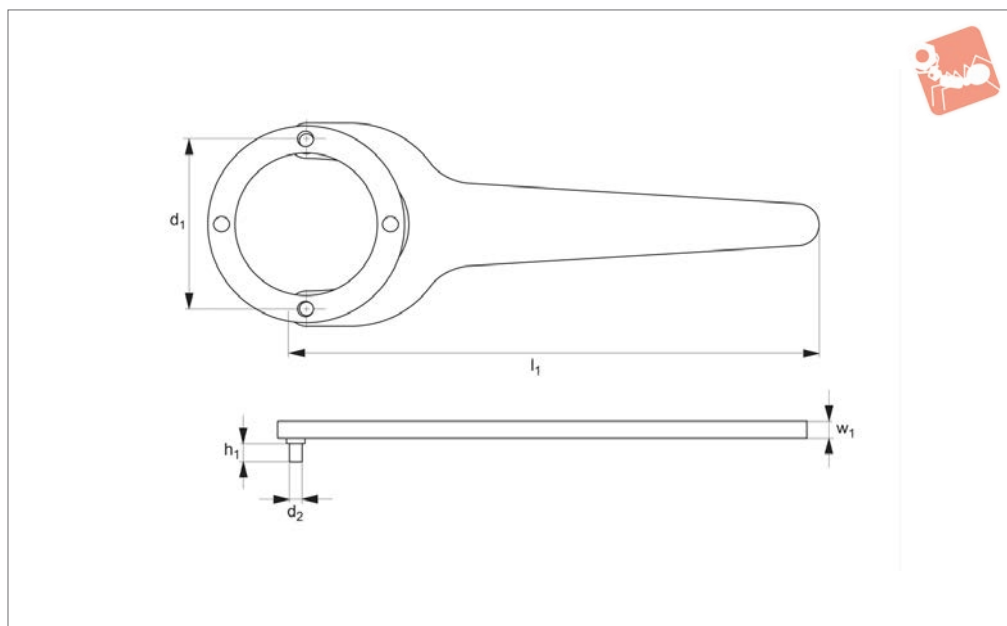

95340

SPANNERS & HOOK SPANNERS

Material

Steel (C35/C45), tempered and blackened.

Pins spot welded.

Technical Notes

Produced to DIN 3116A.

Tips

()= not to DIN standard.

Order No.	d ₁ for nut Ø	d ₂ -0.1 tol. h12	h ₁	l ₁	w ₁	Weight g
95340.W0013	13	2.5	3.0	90	3	27
95340.W0015	15	3.0	3.5	90	3	27
95340.W0020	(20)	3.0	4.0	122	4	50
95340.W0021	(20)	4.0	5.0	122	4	50
95340.W0025	25	3.0	4.0	137	4	65
95340.W0026	(25)	4.0	5.0	137	4	65
95340.W0030	30	4.0	5.0	164	4	85
95340.W0035	35	5.0	6.0	180	5	120
95340.W0036	(35)	4.0	5.0	180	5	120
95340.W0040	40	4.0	5.0	167	5	120
95340.W0045	45	4.0	5.0	187	5	145
95340.W0050	50	5.0	6.0	198	5	175
95340.W0060	60	5.0	6.0	213	6	220
95340.W0075	75	6.0	7.0	243	6	330
95340.W0090	90	7.0	7.5	270	6	410



95342.1

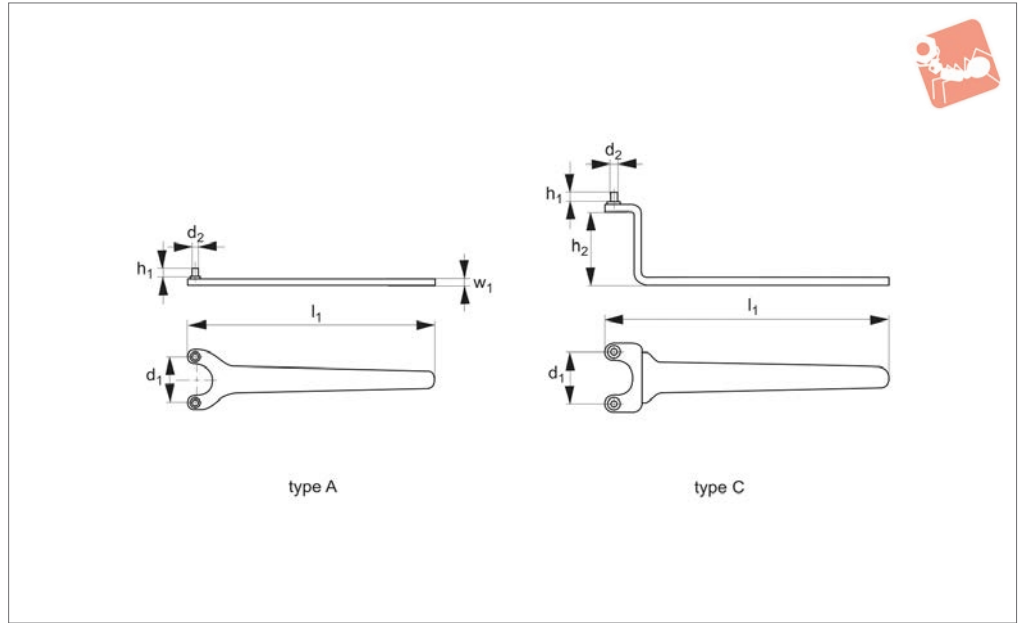

Material

Special steel, zinc plated, with electrically welded pins.

Technical Notes

Size 35 for flange nut DIN 44716-D of angle grinder DIN 44706 for clamping,

grinding and cutting-off wheels.

Order No.	Type	d ₁	d ₂	h ₁	h ₂	l ₁	w ₁	Weight g
95342.W0030	A	30	4	5	-	164	4	85
95342.W0035	A	35	5	6	-	180	5	120
95342.W0135	C	35	-5	6	50	200	5	200



Face Spanner - Off set with fixed pins

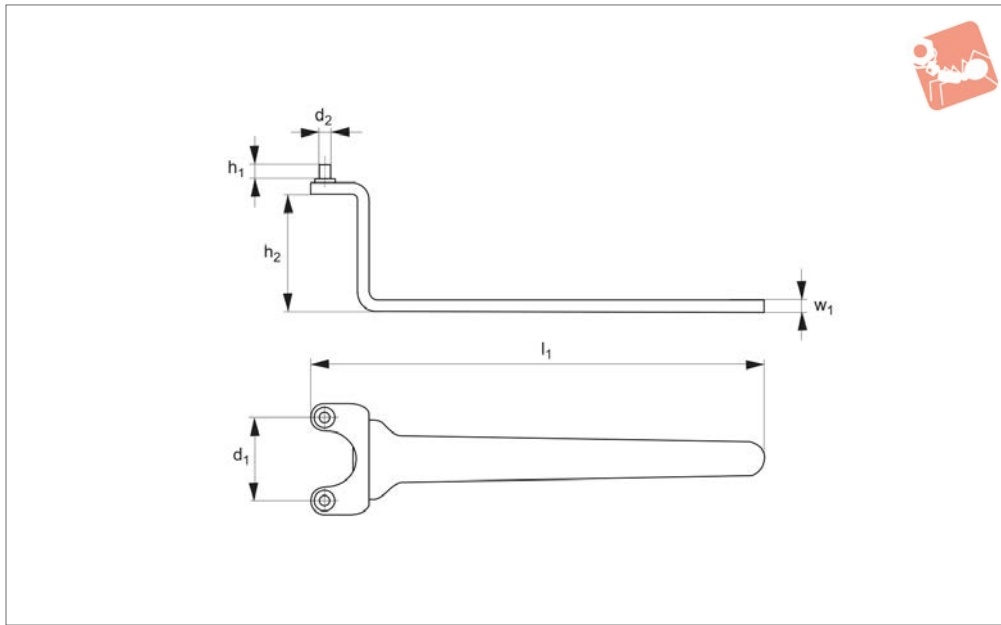

95342.2

SPANNERS & HOOK SPANNERS

Material

Special steel, blued, with electrically welded pins.

belt tensioners (AUDI, VW).

Important Notes

Pin diameter = nominal diameter -0.1mm (tolerance class h12).

Technical Notes

This wrench is used for adjusting timing

Order No.	Type	d ₁	d ₂	h ₁	h ₂	l ₁	w ₁	Weight g
95342.W0118	C	18	3	4	15	140	4	95



95350

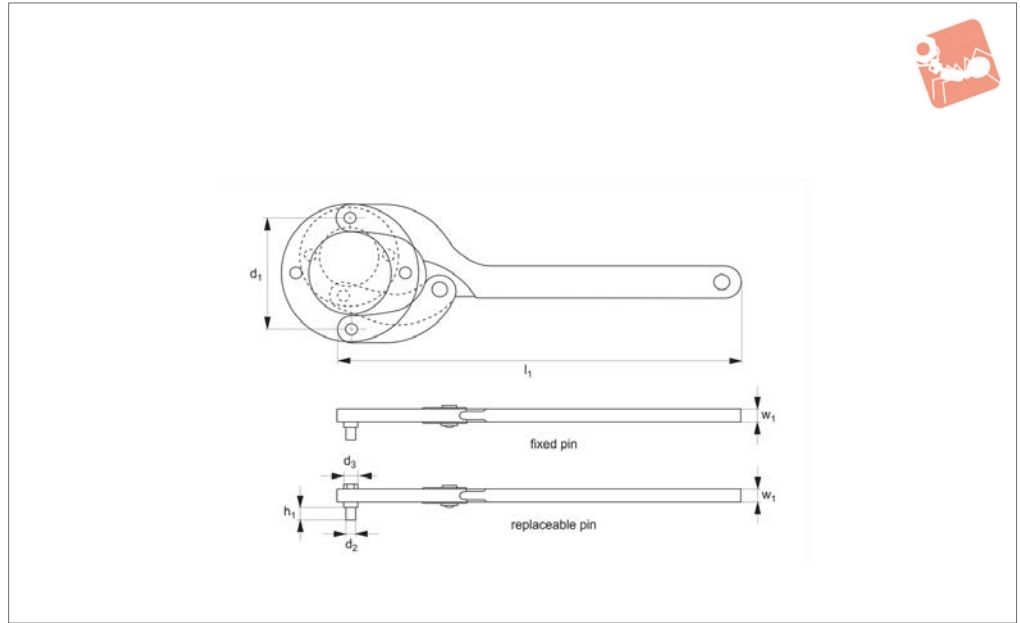

Material

Steel (C35/C45), tempered and blackened.

welded.

For replacement pins see part no. 95360.

Technical Notes

Fixed or replaceable pins, fixed pin spot

Order No.	Type	d ₁ for nut Ø	d ₂ -0.1 tol. h12	d ₃	h ₁	l ₁	w ₁	Weight g
95350.W0041	Fixed Pin	18-40	3	-	4.0	150	5	100
95350.W0042	Fixed Pin	18-40	4	-	5.0	150	5	100
95350.W0081	Fixed Pin	40-80	4	-	5.0	220	6	265
95350.W0082	Fixed Pin	40-80	5	-	6.0	220	6	265
95350.W0083	Fixed Pin	40-80	6	-	7.0	220	6	265
95350.W0125	Fixed Pin	80-125	6	-	7.0	295	8	650
95350.W0126	Fixed Pin	80-125	7	-	7.5	295	8	650
95350.W0127	Fixed Pin	80-125	8	-	8.0	295	8	650
95350.W0201	Fixed Pin	125-200	8	-	8.0	405	10	1590
95350.W0202	Fixed Pin	125-200	10	-	10.0	405	10	1590
95350.W0541	Replaceable Pin	18-40	3	M 4	4.0	150	5	100
95350.W0542	Replaceable Pin	18-40	4	M 4	5.0	150	5	100
95350.W0581	Replaceable Pin	40-80	4	M 6	5.0	220	6	265
95350.W0582	Replaceable Pin	40-80	5	M 6	6.0	220	6	265
95350.W0583	Replaceable Pin	40-80	6	M 6	7.0	220	6	265
95350.W0625	Replaceable Pin	80-125	6	M 6	7.0	295	8	650
95350.W0626	Replaceable Pin	80-125	7	M 6	7.5	295	8	650
95350.W0627	Replaceable Pin	80-125	8	M 6	8.0	295	8	650
95350.W0701	Replaceable Pin	125-200	8	M 8	8.0	405	10	1590
95350.W0702	Replaceable Pin	125-200	10	M 8	10.0	405	10	1590



Adjustable Face Spanner

with replaceable pins - for torque socket wrench

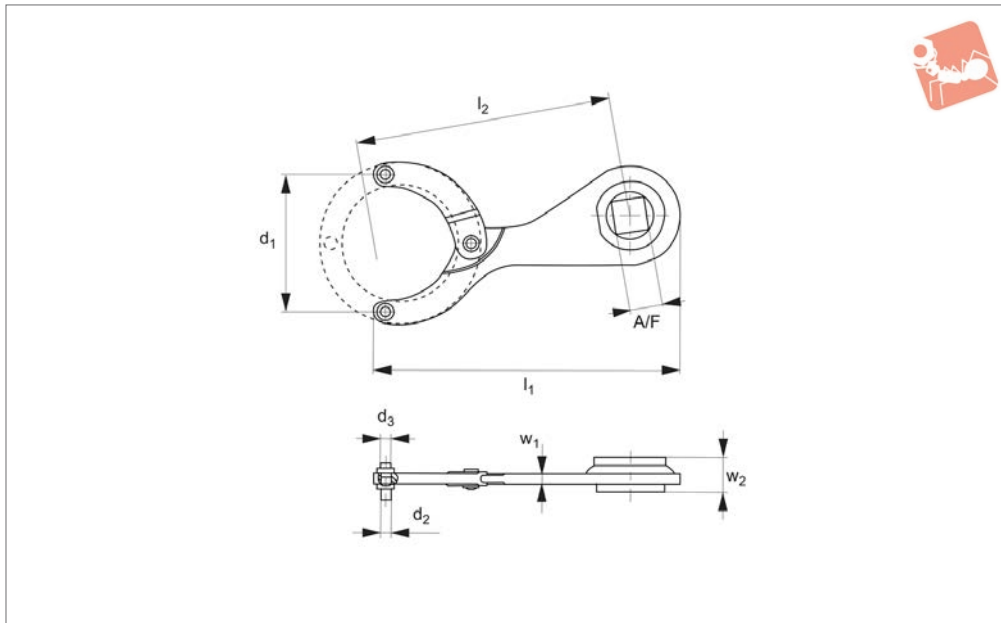

95352

SPANNERS & HOOK SPANNERS

Material

Special steel, hardened and blackened.

Technical Notes

Replaceable, hardened pins.

Pin diameter = nominal diameter -0,1mm (tolerance class h12). See part 95360 for replacement pins.

For use with torque wrench, for more accu-

rate installation and adjustment.

The required torque wrench value is dependent upon dimension l_2 . Please refer to the operating manual of your torque wrench.

Order No.	d_1 for nut \emptyset	d_2 -0.1	d_3	l_1	l_2	w_1	w_2	Drive A/F	Weight g
95352.W0042	18-40	4	M 4	120	100	5	16.0	1/2"	155
95352.W0082	40-80	5	M 6	180	150	6	20.5	3/4"	450
95352.W0083	40-80	6	M 6	180	150	6	20.5	3/4"	455
95352.W0125	80-125	6	M 6	250	220	8	20.5	3/4"	795
95352.W0127	80-125	8	M 6	250	220	8	20.5	3/4"	800



95353

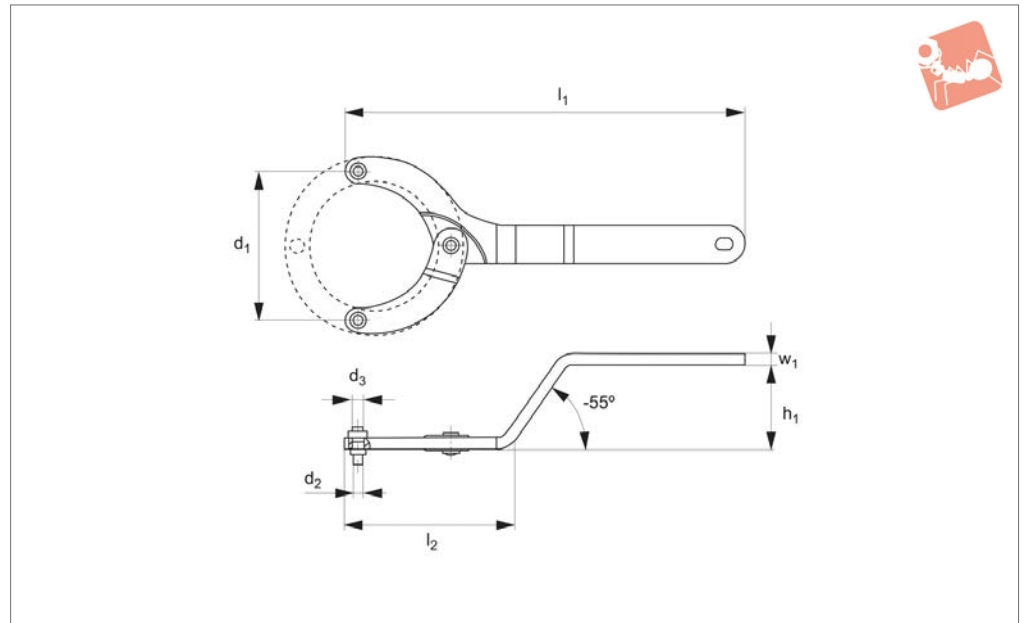

Material

Spanner: steel C35/C45, hardened, with blue finish.

Pins: hardened steel, blackened.

(tolerance class h12). See part 95360 for replacement pins.

Technical Notes

Pin diameter = nominal diameter -0,1mm

Order No.	d ₁ for nut Ø	d ₂ -0.1	d ₃	h ₁	l ₁	l ₂	w ₁	Weight g
95353.W0041	18-40	3	M 4	33	158	57	5	114
95353.W0042	18-40	4	M 4	33	158	57	5	114
95353.W0081	40-80	4	M 6	45	215	92	6	290
95353.W0082	40-80	5	M 6	45	215	92	6	290
95353.W0083	40-80	6	M 6	45	215	92	6	295
95353.W0125	80-125	6	M 6	63	290	130	8	695
95353.W0126	80-125	8	M 6	63	290	130	8	700

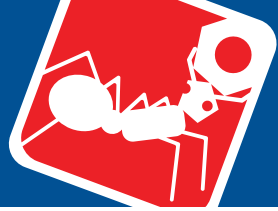

Replacement Pins for face spanners

Spanners & Hook Spanners

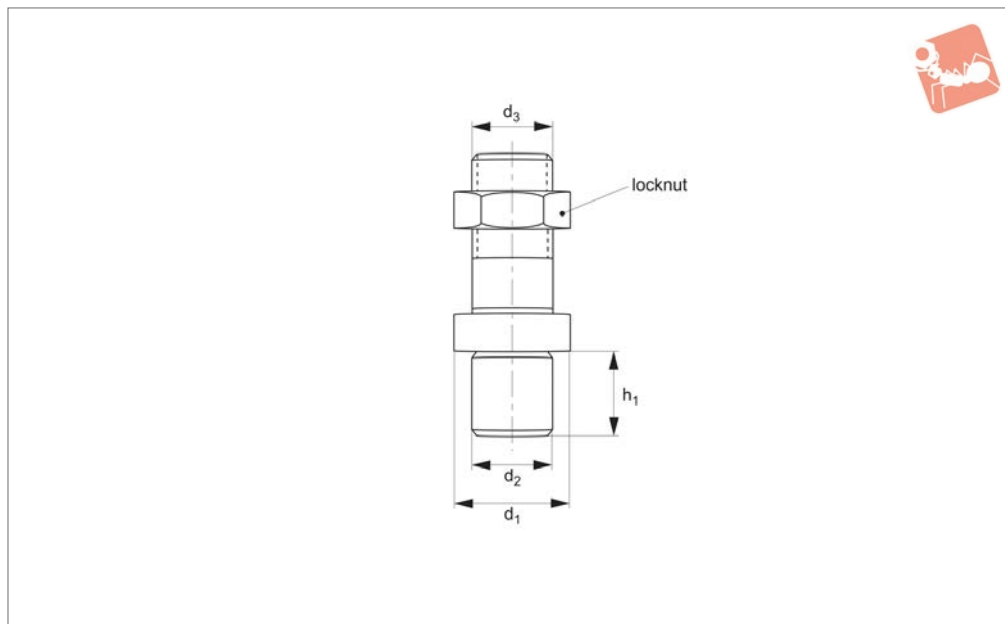

95360

SPANNERS & HOOK SPANNERS

Material

Steel (C35/C45), tempered, hardened, with blue finish.

Technical Notes

Sold as individual pins. Suitable for a variety of spanners, for example 95350,

95352, 95353. See individual product table for pin thread required.

Order No.	d ₁	d ₂ pin tol. h ₁₂ -0,1	d ₃	h ₁	Weight g
95360.W0002	5.5	3	M 4	4.0	2
95360.W0003	7.0	4	M 4	5.0	2
95360.W0010	8.5	4	M 6	4.5	3
95360.W0011	8.5	5	M 6	5.5	5
95360.W0012	10.0	6	M 6	6.5	7
95360.W0013	11.0	7	M 6	7.0	8
95360.W0014	12.0	8	M 6	7.5	9
95360.W0017	12.0	8	M 8	7.5	14
95360.W0019	15.0	10	M 8	9.5	19

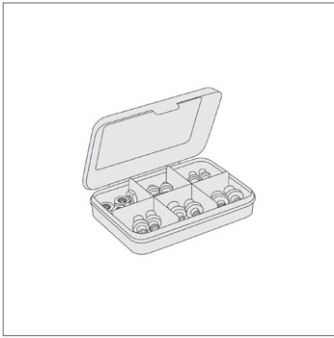

95362



Material

Special steel, hardened and blued.

Technical Notes

Two pins each per size, including nuts in a clearly arranged assortment box.

Order No.	Box l x w x h	For use with 95350, 95352, 95353	Pin diameter -0.1mm tol. h12	Nut (DIN 439)	Weight g
95362.W0006	90 x 65 x 20	40-80 / 80-125	4, 5, 6, 7, 8	10xM 6	95

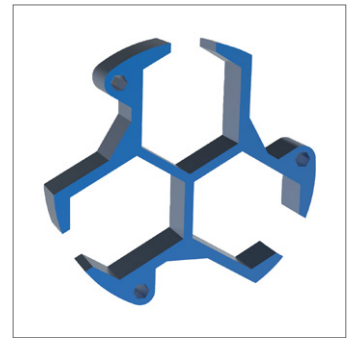
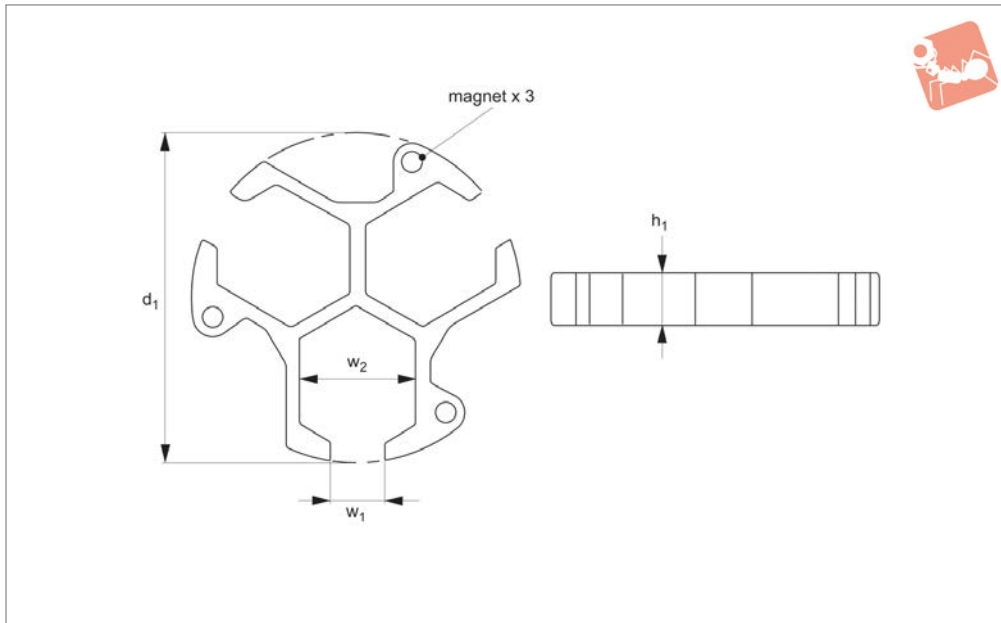
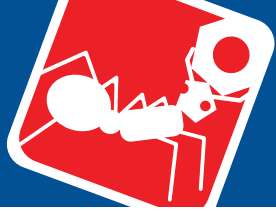

97100

SPANNERS & HOOK SPANNERS

Material

Body: anodised aluminium (high wear resistance).

Technical Notes

The Posi-stop replaces all forms of distance

sleeves and soft jaws normally used when turning short workpieces. They mount securely against the chuck face using three strong magnets and provide a fixed reference surface.

Tips

* w_1 - standard width jaw is 25mm, this can easily be milled or sawn larger for chucks with wider jaws up to 54mm.

Order No.	d_1	h_1 ± 0.01	w_1	w_2	Type
97100.W0015	150	15	25	55	Single
97100.W0020	150	20	25	55	Single
97100.W0025	150	25	25	55	Single
97100.W0030	150	30	25	55	Single
97100.W0035	150	35	25	55	Single
97100.W0040	150	40	25	55	Single
97100.W0503	-	1 of each - 15, 20, 25	-	-	Set of 3
97100.W0504	-	1 of each - 15, 20, 25, 30	-	-	Set of 4
97100.W0505	-	1 of each - 15, 20, 25, 30, 35	-	-	Set of 5
97100.W0506	-	1 of each - 15, 20, 25, 30, 35, 40	-	-	Set of 6



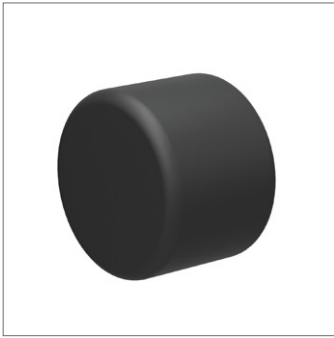

97103

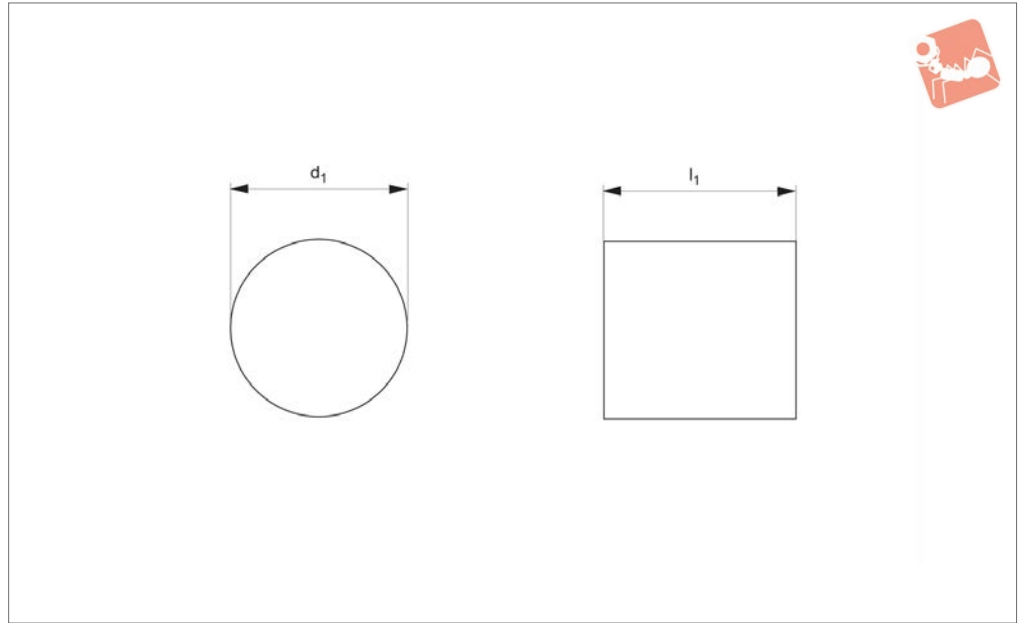

Material

Flame resistant neoprene foam.

through holes to keep swarf and coolant from the spindle bore.
Just squeeze the plug into the chuck hole.

Technical Notes

The chuck plug is used to plug lathe chuck

Order No.	d ₁	Optimal bore length l ₁	Bore length l ₁ min. max.	Qty/pack
97103.W0035	35	33	30-34	2
97103.W0048	48	45	42-47	2
97103.W0055	55	52	49-54	2
97103.W0070	70	66	62-68	2
97103.W0080	80	75	72-78	2
97103.W0086	86	81	76-83	2
97103.W0097	97	91	87-94	2
97103.W0107	107	100	97-104	2
97103.W0113	113	106	100-109	2

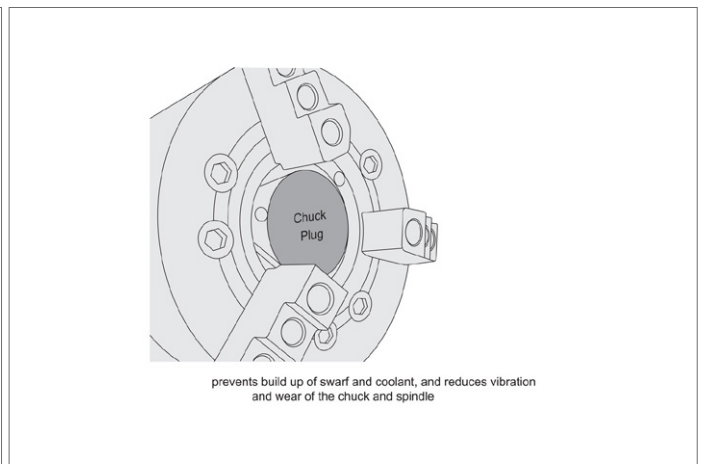
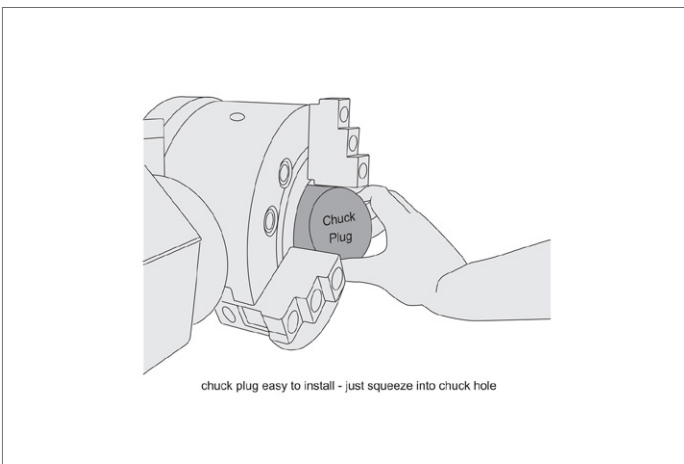

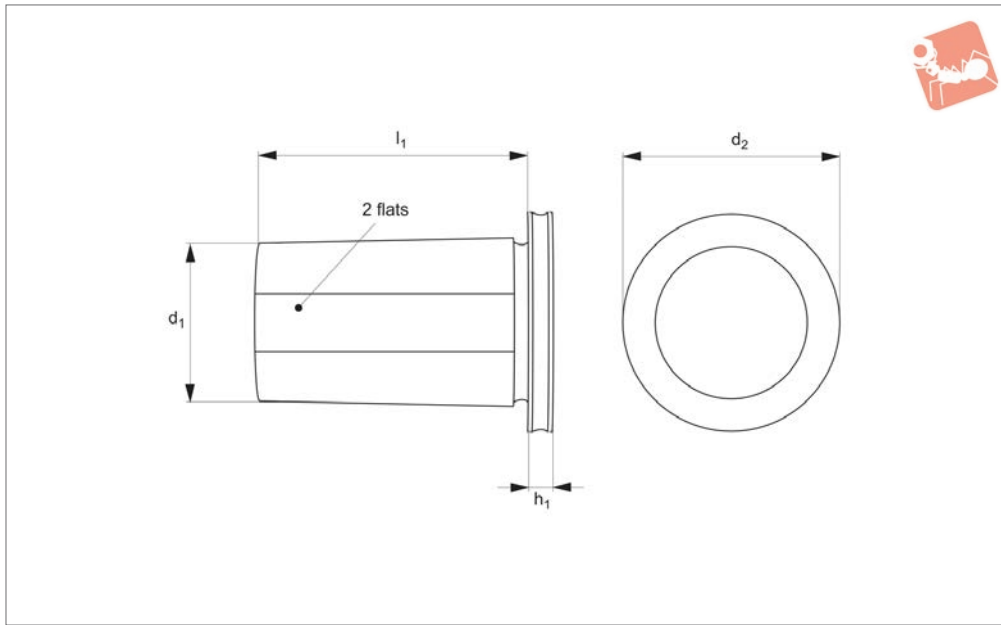

97104

SPANNERS & HOOK SPANNERS

Material

Body: aluminium (hard coat anodized).

coolant build up in boring bar holders, and as a result also prolongs tool holder life.

Technical Notes

The bore plug is used to prevent swarf and

Order No.	d ₁	h ₁	l ₁	d ₂	Type
97104.W0025	25	6.4	68.5	36.5	Metric
97104.W0032	32	6.4	68.5	42.9	Metric
97104.W0040	40	6.4	68.5	49.2	Metric
97104.W0050	50	6.4	68.5	61.9	Metric
97104.W0100I	1"	0,25"	2,75"	1,44"	Inch
97104.W0125I	1-1/4"	0,25"	2,75"	1,69"	Inch
97104.W0150I	1-1/2"	0,25"	2,75"	1,94"	Inch
97104.W0200I	2"	0,25"	2,75"	2,44"	Inch

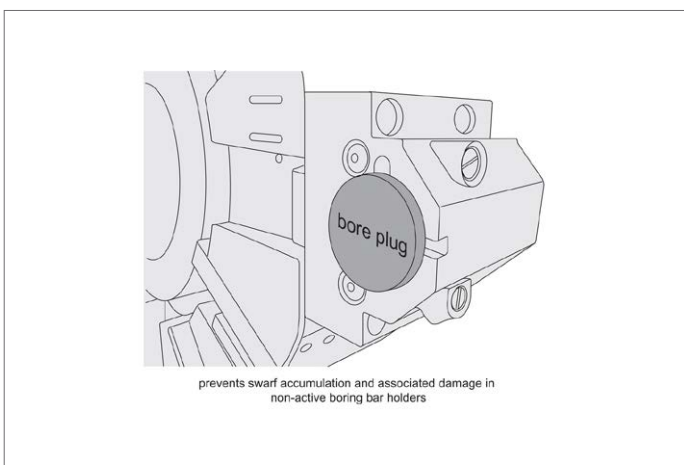



97100 Posi-Stops

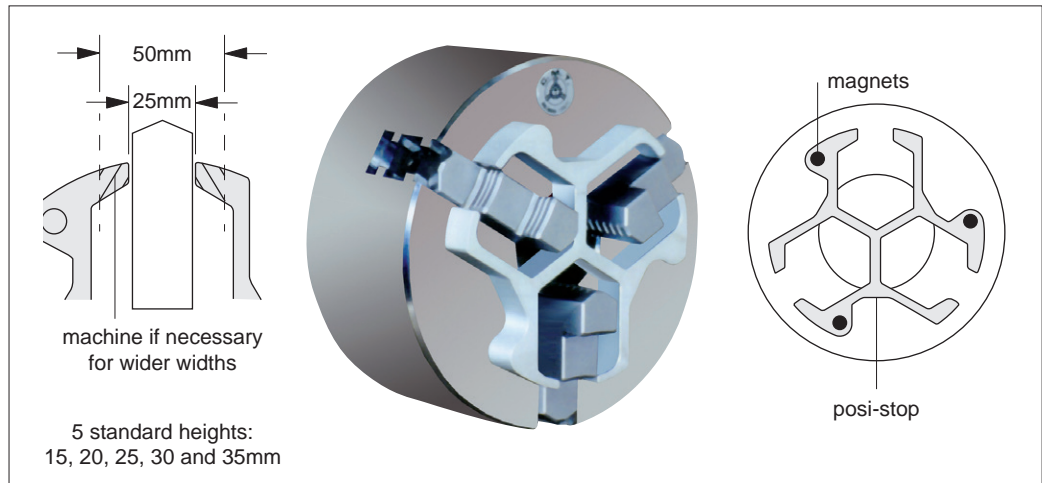

Chuck “Posi-stops” provide a quick and accurate method of moving workpieces away from the face of the chuck. Often used to enable the workpiece to be machined more closely to its extremity or for shorter workpieces.

Each posi-stop has strong magnets on the bottom face so that the stop snaps firmly over the chuck jaws and onto the chuck face. There are five standard thicknesses; 15, 20, 25, 30 and 35mm (accuracy $\pm 0.01\text{mm}$) or they can be purchased as a set.

The posi-stops are made for a standard jaw width of 25mm but they can easily be opened up (mill or saw) to accommodate wider jaw widths.

97103 Chuck Puck

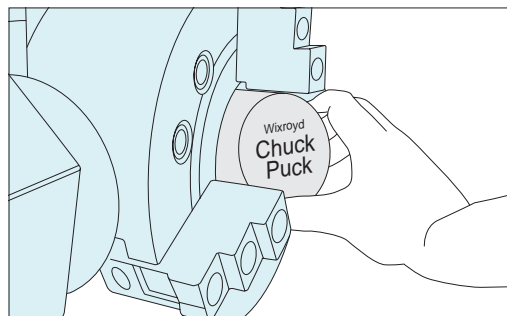

Chuck plug easy to install - just squeeze into the chuck hole.

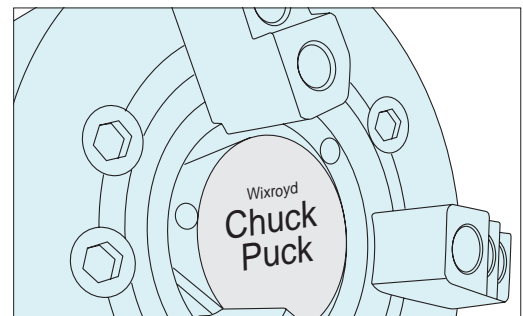

Prevents build up of swarf and coolant, reduces vibration as well as wear of the chuck and spindle.

97104 Bore Plug

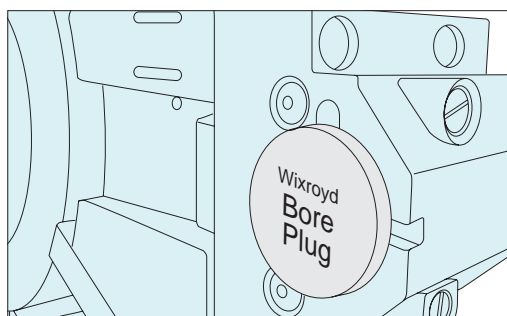

Prevents swarf accumulation and associated damage in non-active boring bar holders.

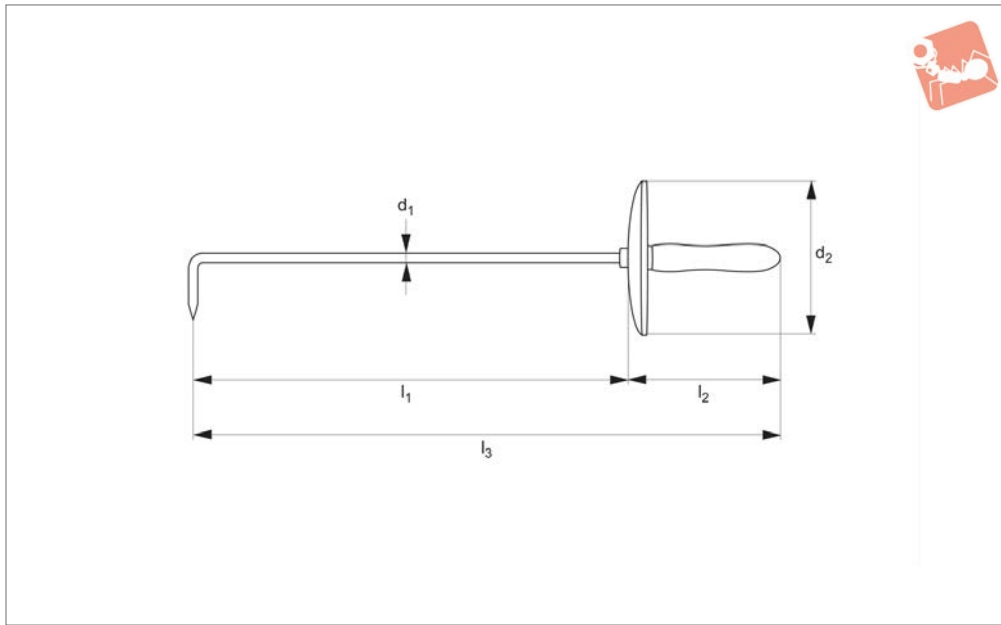

97050

SPANNERS & HOOK SPANNERS

Material

Hook and guard: steel.
Handle: wood.

Technical Notes

Excellent for removing swarf or chips from in and around workpieces for mills and

lathes. Extended hook minimises risk to operator.
Part number 97050.W2050 has rigid fixing (brazed-soldered).
All other parts have flexible fixing (rubber).

Important Notes

Take all necessary safety precautions when using this product in or around working machinery. If in doubt shut down machine.

Order No.	Guard fixing	d ₁	l ₁	l ₂	l ₃	d ₂
97050.W2020	Flexible-circlip	5	180	125	305	115
97050.W2030	Flexible-circlip	6	280	130	410	130
97050.W2040	Flexible-circlip	6	400	130	530	140
97050.W2050	Rigid-welded	6	400	130	530	140

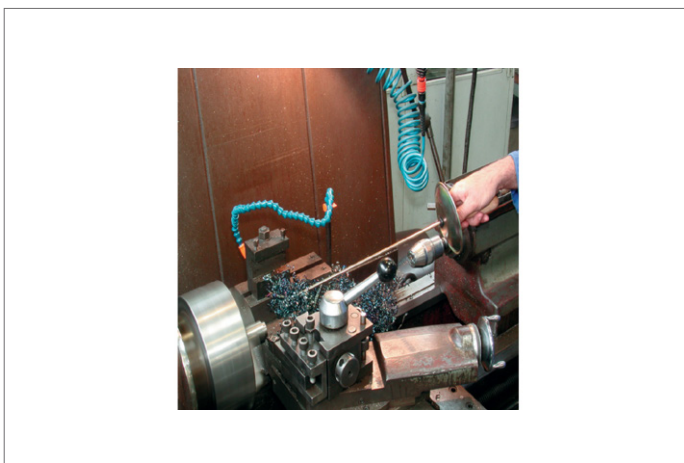



97052

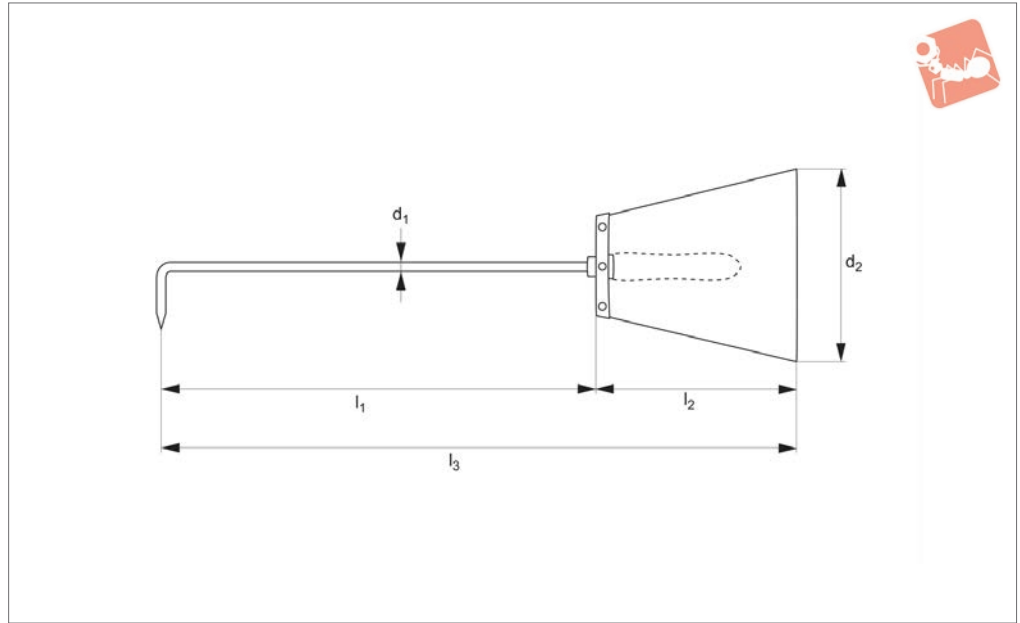

Material

Hook: steel.
Guard: plastic.
Handle: wood.

Technical Notes

Excellent for removing swarf or chips from

in and around workpieces for mills and lathes. Extended hook minimises risk to operator.

Important Notes

Take all necessary safety precautions when using this product in or around working

machinery. If in doubt shut down machine.

Order No.	d ₁	l ₁	l ₂	l ₃	d ₂
97052.W2060	6	400	180	570	180
97052.W2070	7	500	180	670	180



Chip Hooks

full plastic guard - long handle

Spanners & Hook Spanners

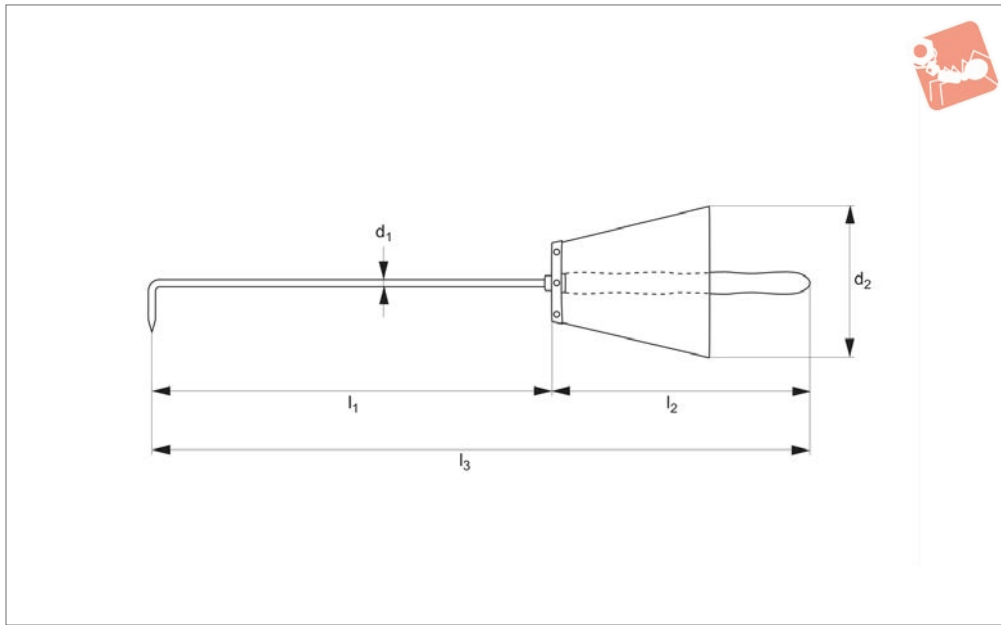

97053

SPANNERS & HOOK SPANNERS

Material

Hook: steel.
Guard: plastic.
Handle: wood.

in and around workpieces for mills and lathes. Extended hook minimises risk to operator.

machinery. If in doubt shut down machine.

Technical Notes

Excellent for removing swarf or chips from

Important Notes

Take all necessary safety precautions when using this product in or around working

Order No.	d ₁	l ₁	l ₂	l ₃	d ₂
97053.W2080	7	500	320	820	180
97053.W2090	8	800	320	1120	180
97053.W2100	8	1000	320	1320	180



97060

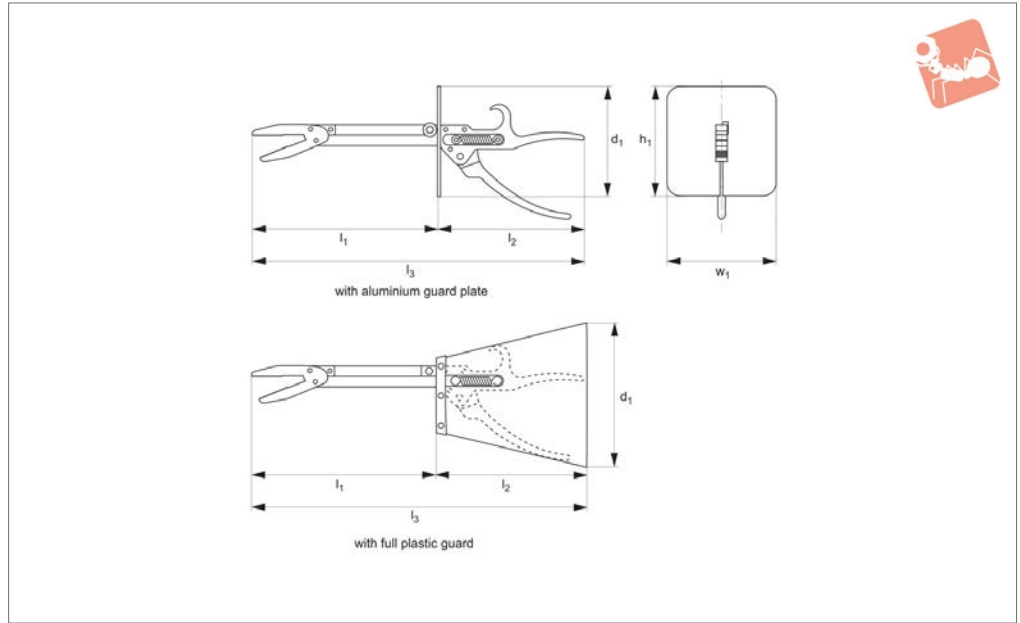

SPANNERS & HOOK SPANNERS

Material

Handle and cutter: steel.
Guard: plastic or aluminium.

Important Notes

Take all necessary safety precautions when using this product in or around working

machinery. If in doubt shut down machinery.

Order No.	Guard material	d ₁	h ₁ x w ₁	l ₁	l ₂	l ₃
97060.W1025	Aluminium	-	85x85	175	155	330
97060.W1035	Plastic	180	-	175	180	355



Chip Cutter and Hook with hand guard

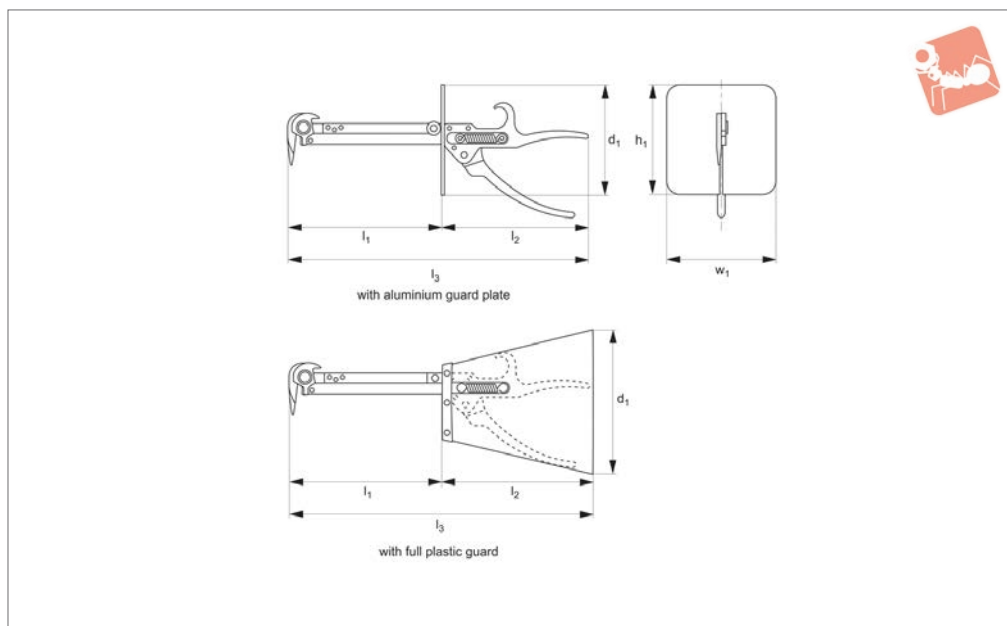

97061

Material

Handle and cutter: steel.
Guard: plastic or aluminium.

Technical Notes

Max. capacity of cutter is clip section of

1,5mm² (e.g. 0,25mm x 6mm).

Tips

Part no. 97061 has added benefit of hook as well as cutter for improved removal of difficult to reach swarf/chips.

Important Notes

Take all necessary safety precautions when using this product in or around working machinery. If in doubt shut down machinery.

Order No.	Guard material	d ₁	h ₁ x w ₁	l ₁	l ₂	l ₃
97061.W1050	Aluminium	-	85x85	165	155	320
97061.W1060	Plastic	180	-	165	180	345

